

NOTICE!!

These documents have been scanned!

Do not place un-scanned documents beneath this notice!

Do not remove this notice from this file!

GPO Jacket No. 560-102
Print Order 61540
Rise Business Services, LLC
Job=AZ15 7/3/2019



Box Number= AZ15140



Claim Begin-End: AMC352455-AMC352456

1 Initial Receipt



AZ15140-14

AMC351599-AMC352455

CLAIM INDEX

DATE PREPARED: November 30, 1999

LEAD AMC NUMBER: AMC 352455
THRU
ENDING AMC NUMBER: AMC

<u>AMC NUMBER</u>	<u>*CLOSURE DECISION</u>	<u>CLAIM NAME</u>	<u>LOCATORS OF RECORD</u>
AMC 352455		ABSM-I-R	HAL J. BROSTROM CLARK BROWN DON JARES DON KLINE DEANNA W. KLINELL DREW J. KLINELL GEORGE KLINELL JOHN PEASE
AMC 352456		ABSM-II-R	“ ”

***FOR BLM PURPOSES ONLY**

UNITED STATES
DEPARTMENT OF THE INTERIOR
BUREAU OF LAND MANAGEMENT

RECEIPT AND ACCOUNTING ADVICE

NO. 2348087 07

CD/AZ

09/08/99

Subject: LOCATION & SERVICE FEES (2) 3 16 61 50.00
CLAIM MAINTENANCE FEES 2000 (2) 3 16 42 20.00
Applicant: 3 16 53 200.00

GEORGE KLINELL
8474 S TREASURE MTN DR
SANDY UTAH 84093

CC

Remitter: 801-944-1313

ENTERED IN COMPUTER

10/6/99 &

Assignor:

LEASE MANAGEMENT DATA NEW UPDATE PAYMENT

ORIGINAL SERIAL NO.	ASG.	TYPE	ST.	CTY.	FUND SYMBOL	ACRES/UNITS	RATE
AMC 352455 & 352456							

AMOUNT	ANV. DATE	EXP. DATE	BILL CYC.	S/C	DISTRICT	NEXT BILL	MISC. DATA	U of M	ACTUAL UNITS

ASSIGNMENT SERIAL NO.	ASG.	TYPE	ST.	CTY.	FUND SYMBOL	ACRES/UNITS	RATE

AMOUNT	ANV. DATE	EXP. DATE	BILL CYC.	S/C	DISTRICT	NEXT BILL	MISC. DATA	U of M	ACTUAL UNITS

APPLY REMITTANCE

ACTION	FUND SYMBOL	CTY.	AMOUNT
FILING FEE			
RENTAL			
UNEARNED			
REFUND			
TOTAL			
AMOUNT DUE			

Remarks:

BY:

DATE:

Lease in Escrow?
 KGS? Of Interest?
 Auto Escalates? Operating Rights?
 Auto Renew? Operator
 Bond Filed?

FOR MMS USE ONLY

BILLEE NUMBER	FOREST REFUGE
OCS SECTION CODE	

UNITED STATES
DEPARTMENT OF THE INTERIOR
BUREAU OF LAND MANAGEMENT

RECEIPT AND ACCOUNTING ADVICE

NO. 2348087 07

CD/AZ

09/08/99

*Rec'd MC
9-30-99*

Subject: LOCATION & SERVICE FEES (2) 3 16 61 50.00
 CLAIM MAINTENANCE FEES 2000 (2) 3 16 42 20.00
 Applicant: 3 16 53 200.00

GEORGE KLINELL
8474 S TREASURE MTH DR
SANDY UTAH 84093

CC

Remitter: 801-944-1313

Assignor:

10/6/99

LEASE MANAGEMENT DATA NEW UPDATE PAYMENT

ORIGINAL SERIAL NO.	ASG.	TYPE	ST.	CTY.	FUND SYMBOL	ACRES/UNITS	RATE
AMC 352455 & 352456							

AMOUNT	ANV. DATE	EXP. DATE	BILL CYC.	S/C	DISTRICT	NEXT BILL	MISC. DATA	U of M	ACTUAL UNITS

ASSIGNMENT SERIAL NO.	ASG.	TYPE	ST.	CTY.	FUND SYMBOL	ACRES/UNITS	RATE

AMOUNT	ANV. DATE	EXP. DATE	BILL CYC.	S/C	DISTRICT	NEXT BILL	MISC. DATA	U of M	ACTUAL UNITS

APPLY REMITTANCE

ACTION	FUND SYMBOL	CTY.	AMOUNT
FILING FEE			
RENTAL			
UNEARNED			
REFUND			
TOTAL			
AMOUNT DUE			

Remarks:

BY: _____ DATE: _____

- Lease in Escrow?
- KGS? Of Interest?
- Auto Escalates? Operating Rights?
- Auto Renew? Operator
- Bond Filed?

FOR MMS USE ONLY

BILLEE NUMBER	FOREST REFUGE
OCS SECTION CODE	

NOTICE!!

These documents have been scanned!

Do not place un-scanned documents beneath this notice!

Do not remove this notice from this file!

GPO Jacket No. 560-102
Print Order 61540
Rise Business Services, LLC
Job=AZ15 7/3/2019



Box Number= AZ15140



Claim Begin-End: AMC352455-AMC352456

2 Correspondence



AZ15140-14

AMC351599-AMC352455



United States Department of the Interior



BUREAU OF LAND MANAGEMENT

Arizona State Office

One North Central Avenue, Suite 800

Phoenix, Arizona 85004-4427

www.blm.gov/az/

In Reply Refer To:

3800 (9310) AT

AMC345615, AMC352455

CERTIFIED MAIL – RETURN RECEIPT REQUEST 7011 2970 0002 3234 9402

NOTICE

KLINELL GEORGE, ET AL
2936 SIERRA POINT PLACE
SALT LAKE CITY, UT 84109

This Notice Affects Those Claims
Shown in the Block Below.

AMC345615 - 345622, 352455, 352456
ABS-I - VIII, ABSM I-R, II-R

2013 Maintenance Fees - Additional Fees Required

Your maintenance fee payment for the 2013 assessment year, in the amount of \$140 per claim, for the placer claims listed above, has been received and is insufficient. **The total due on your claim(s) is: \$9800.**

In accordance with the Consolidated Appropriations Act of 2012, Public Law 112-74 (125 Stat 1047), and FR44155-44158 (2012) Congress changed the way maintenance fees for placer mining claims are assessed. Instead of charging the maintenance fee on a per-claim basis, Congress stated that the fee, which is currently \$140, will be assessed on each 20 acre parcel of a placer claim or portion thereof.

Insufficient payment of the annual maintenance fee for the 2013 assessment year is a curable defect. **Therefore you are required to do one of the following within 30 days of receipt of this notice or your claim(s) will be declared forfeited:** 1) submit additional fees of \$140 per 20-acres or portion thereof based on the full acreage of the claim, or 2) amend the claim(s) to reduce the acres so a lesser fee is due and submit any additional fees due; or 3) relinquish the claim(s) in their entirety, in which case BLM will refund the maintenance fees you have already paid for the 2013 assessment year.

If you choose to amend the claims to reduce the acres, you must submit an amended location notice for each claim, with an accurate description and dimensions of the reduced claim, along with a map depicting the reduced claim, and a \$10 processing fee per amendment. An amendment must also be recorded at the county. If the amended claim contains more than 20 acres, calculate the additional fees due and submit those fees with the amendment(s).

pd \$7,800 11/28/12 HT

Please include your Arizona Mining Claim (AMC) serial number(s) and claim name(s) when submitting the additional fees, and note that you are paying additional fees due. If additional information is required, please contact Amy Thrower at 602-417-9334.

Rebecca Heick

Rebecca Heick
Group Administrator
Lands and Minerals

SENDER: COMPLETE THIS SECTION	COMPLETE THIS SECTION ON DELIVERY
<ul style="list-style-type: none"> Complete Items 1, 2, and 3. Also complete item 4 if Restricted Delivery is desired. Print your name and address on the reverse so that we can return the card to you. Attach this card to the back of the mailpiece, or on the front if space permits. 	<p>A. Signature <input type="checkbox"/> Agent <input type="checkbox"/> Addressee</p> <p>B. Received by (Printed Name) C. Date of Delivery</p>
<p>1. Article Addressed to:</p> <p>KLINELL GEORGE, ET AL 2936 SIERRA POINT PLACE SALT LAKE CITY, UT 84109</p> <p>AMC345615 - 345622, 352455, 352456</p>	<p>D. Is delivery address different from Item 1? <input type="checkbox"/> Yes If YES, enter delivery address below: <input type="checkbox"/> No</p> <p>NOV 02 2012</p> <p>3. Service Type</p> <p><input type="checkbox"/> Certified Mail <input type="checkbox"/> Express Mail</p> <p><input type="checkbox"/> Registered <input type="checkbox"/> Return Receipt for Merchandise</p> <p><input type="checkbox"/> Insured Mail <input type="checkbox"/> C.O.D.</p> <p>4. Restricted Delivery? (Extra Fee) <input type="checkbox"/> Yes</p>
<p>2. Article Number (Transfer from service label) 7011 2970 0002 3234 9402</p>	
<p>PS Form 3811, February 2004 Domestic Return Receipt 102595-02-M-1540</p>	

UNITED STATES POSTAL SERVICE

SALT LAKE CITY UT 84109

First-Class Mail
Postage & Fees Paid
USPS
Permit No. G-10

RECEIVED
BLM AZ STATE OFFICE
2012 NOV 02 P 2:11
PHOENIX, ARIZONA

• Sender: Please print your name, address, and ZIP+4 in this box •

Bureau of Land Management
Arizona State Office
One North Central Avenue, Ste 800
Phoenix, AZ 85004-4427

NOV 02 2012 PM 11

NOTICE!!

These documents have been scanned!

Do not place un-scanned documents beneath this notice!

Do not remove this notice from this file!

GPO Jacket No. 560-102
Print Order 61540
Rise Business Services, LLC
Job=AZ15 7/3/2019



Box Number= AZ15140



Claim Begin-End: AMC352455-AMC352456

3 Transfers



AZ15140-14

AMC351599-AMC352455

**NO
DOCUMENTS
FOUND**

NO DOCUMENTS FOUND
NO DOCUMENTS FOUND

NOTICE!!

These documents have been scanned!

Do not place un-scanned documents beneath this notice!

Do not remove this notice from this file!

GPO Jacket No. 560-102
Print Order 61540
Rise Business Services, LLC
Job=AZ15 7/3/2019



Box Number= AZ15140



Claim Begin-End: AMC352455-AMC352456

4 Annual Filings



AZ15140-14

AMC351599-AMC352455

352455

August 27, 2020

Sent via Federal Express

Bureau of Land Management
Arizona State Office
One North Central Avenue – Suite 800
Phoenix, Arizona 85004-4427

RE: MAINTENANCE FEE PAYMENTS

Enclosed you will find a check for \$1,320.00 issued to the Bureau of Land Management – Arizona, to cover the annual mining claim maintenance fee for our Arizona Claim.

Claim ABSM I-R. BLM serial number 352455.

Please send the receipt to agent/associate Hal Brostrom (address listed below).

Sincerely,



Hal J Brostrom
330 Box Elder Drive
Grantsville, UT 84029
Phone (435) 830-3932

ENTERED
SEP 08 2020
BY: MW

NO. OF CLAIMS ASSOC. PLACER
AMOUNT \$1320.
RECEIPT NO. 4796885
INIT. EBC

** BLM-ASO**

RECEIVED
BLM AZ STATE OFFICE
2020 SEP - 1 A 9 28
PHOENIX, ARIZONA

UNITED STATES
DEPARTMENT OF THE INTERIOR
BUREAU OF LAND MANAGEMENT
**MAINTENANCE FEE PAYMENT FORM
FOR PLACER MINING CLAIMS**

Remitter Name <u> </u> HAL J BROSTROM Mailing Address: <u> </u> P.O. BOX 536 City, State, Zip: <u> </u> GRANTSVILLE, UT 84029 <input type="checkbox"/> Check here if this is a change of address.	<p align="center">FOR COUNTY RECORDER'S USE</p>
---	--

No. of claims 1
Total due BLM \$ 1,320.00

1. The maintenance fee may be paid by cash, check, money order, Bureau of Land Management (BLM) Declining Deposit Account, or credit card (VISA, American Express, Discover, or MasterCard). Payments must be remitted to the BLM State Office where your claim or site is recorded and received on or before September 1. If the payment is mailed, the envelope must be postmarked by a bona fide delivery service on or before September 1 and received at the proper BLM State Office within 15 calendar days after the due date. Payments may also be made by telephone using a credit card. A complete listing of BLM State Offices with their addresses and phone numbers can be found at <http://www.blm.gov>.
2. The maintenance fee for the following claim(s) applies to the assessment year 2020 .

CLAIM NAME	BLM SERIAL NO.	ACRES IN CLAIM	PAYMENT DUE TO THE BLM <small>(See Instructions on Page 2)</small>
ABSM I-R	██████████ 352455	160	\$ 1,320.00

RECEIVED
 BLM AZ STATE OFFICE
 PHOENIX, ARIZONA
 2020 SEP - 1 A 9 28

Use a separate sheet for additional claim names, serial numbers, and claimant names and addresses.

8/27/2020

INSTRUCTIONS

1. This is an optional form that may be used to satisfy the requirements for the Bureau of Land Management (BLM) under the provisions of 43 U.S.C. §1744 and 30 U.S.C. §28f and the regulations thereunder (43 CFR part 3834). Since local and State laws may vary, you should contact your local and State agencies where the claims are located to ensure all applicable laws and requirements are satisfied.
2. This form should be used to pay the maintenance fee for placer mining claims only. To pay the maintenance fee for lode mining claims, mill sites or tunnel sites, use Form 3830-5.
3. Complete the section for the number of claims and the amount being remitted to the BLM.
4. Enter the year in paragraph 2 for the applicable assessment year.
5. List all mining claim names and the BLM serial number associated to the claim if the BLM has notified you what the serial number is. Every attempt should be made to include the current BLM serial number for each claim listed. List the acreage for each claim and the amount due based on the acreage. See the chart below for amounts due.
6. The maintenance fee for placer mining claims is paid for every 20 acres of the claim or portion thereof. When making a maintenance fee payment for your placer claim, you should make your payment in accordance with the following chart:

Number of acres in the claim	Maintenance Fee Payment Due Per Claim
< = 20 acres	\$140
> 20 acres but < = 40 acres	\$280
> 40 acres but < = 60 acres	\$420
> 60 acres but < = 80 acres	\$560
> 80 acres but < = 100 acres	\$700
> 100 acres but < = 120 acres	\$840
> 120 acres but < = 140 acres	\$980
> 140 acres but < = 160 acres	\$1,120
> 160 acres	Contact the BLM <i>\$1320</i>

Legend: > means greater than; < means less than; = means equal to

per phone confirmation

7. The name and current mailing addresses of the person paying the maintenance fee(s) should be listed at the top of the form. If this is a change of address for a claimant, that should also be noted.
8. If needed, an additional sheet can be used to continue listing claim names, BLM serial numbers, acres in claim, payment due or the name and current mailing address of additional claimants.
9. If paying by credit card, you must complete the following credit card information on page 4: (a) exact name on the face of the credit card; (b) amount paid; (c) type of card; (d) credit card number; (e) expiration date of the card; and (f) telephone number. You must also sign page 4 to show authorization to charge the credit card.

NOTICES

THE PRIVACY ACT and 43 CFR 2.48(d) require that you be furnished with the following information in connection with the information requested by this form.

AUTHORITY: 30 U.S.C. 28f and 43 CFR part 3834 permit collection of the information requested by this form.

PRINCIPAL PURPOSE: The BLM will use the information you provide to record the annual maintenance fee payment for the claims listed and to verify that payment has been made in accordance with 30 U.S.C. 28f and 43 CFR part 3834.

ROUTINE USES: The BLM will only disclose this information in accordance with the provisions at 43 CFR 2.56(b) and (c) and 30 U.S.C. 28f and 43 CFR part 3834 for claimants paying the annual maintenance fee. The use of this specific form when paying the maintenance fee is optional. However, when paying the maintenance fee, it is the requested information on this form that is required to be submitted along with the fee. Failure to submit all the required information will delay the BLM's processing of the information and may preclude the BLM's acceptance of the maintenance fee payment, which may result in forfeiture of the mining claim(s) by the claimant.

RECEIVED
 BUREAU OF LAND MANAGEMENT
 PHOENIX, ARIZONA
 MAR 11 10 28 AM '08

PRESS FIRMLY TO SEAL

PRESS FIRMLY TO SEAL



1004



85004

U.S. POSTAGE PAID
PM 2-Day
GRANTSVILLE, UT
84029
AUG 27 20
AMOUNT
\$7.75
R2305E123588-01



FROM: HAL Brostrom
P.O. Box 536
Grantsville, UT 84029



This envelope is made from post-consumer waste. Please recycle - again.

PRIORITY[®] MAIL

- Date of delivery specified*
- USPS TRACKING™ included to many major international destinations.
- Limited international insurance.
- Pick up available.*
- Order supplies online.*
- When used internationally, a customs declaration label may be required.

EXPECTED DELIVERY DAY: 08/31/20

USPS TRACKING® NUMBER



9505 5161 9022 0240 2636 64

8
1/2

To schedule free
Package Pickup,
scan the QR code.



USPS.COM/PICKUP

TO:

RECEIVED
BLM AZ STATE OFFICE
2020 SEP - 1 A 9 28
PHOENIX, ARIZONA

BUREAU of LAND Management
ARIZONA STATE OFFICE
ONE NORTH CENTRAL AVE.
Suite 800
PHOENIX, AZ 85004-4427
85004-4427

This packaging is the property of the U.S. Postal Service® and is provided solely for use in sending Priority Mail® shipments. Misuse may be a violation of federal law. This packaging is not for resale. EPI/AF © U.S. Postal Service; October 2018; All rights reserved.

United States Department of the Interior
Bureau of Land Management
 DIV OF LANDS, MINRLS & ENERGY
 ONE N CENTRAL AVE
 PHOENIX, AZ 85004 -4427
 Phone: 602-417-9200

Receipt

No: **4796885**

Transaction #: 4924074	
Date of Transaction: 09/03/2020	
CUSTOMER:	
HAL J BROSTROM PO BOX 536 GRANTSVILLE, UT 84029-0536 US	

LINE #	QTY	DESCRIPTION	REMARKS	UNIT PRICE	TOTAL
1	1.00	LOCATABLE MINERALS / MINING CLAIMS- NOT NEW-UNADJUD, ONE AUTH NO. ONLY / MINING CLAIM MONEY RECEIVED CASES: AMC352455/\$1320.00	21 MAINT (1)	- n/a -	1320.00
TOTAL:					\$1,320.00

PAYMENT INFORMATION			
1	AMOUNT:	1320.00	POSTMARKED: N/A
	TYPE:	CHECK	RECEIVED: 09/01/2020
	CHECK NO:	4000542137	
	NAME:	BROSTROM, HAL J PO BOX 536 GRANTSVILLE UT 84029-0536 US	

REMARKS

This receipt was generated by the automated BLM Collections and Billing System and is a paper representation of a portion of the official electronic record contained therein.

Amc 352455

August 21, 2019

Arizona State Office
One North Central Avenue – Suite 800
Phoenix, Arizona 85004-4427

RECEIVED
BLM AZ STATE OFFICE
2019 AUG 23 P 3:02
PHOENIX, ARIZONA

RE: MAINTENANCE FEE PAYMENTS

Enclosed you will find a cashier's check in amount of \$2,640.00 to cover annual mining claim maintenance fees for our Arizona Claims.

AMC Claims # 352455 (ABSM I-R) and # 352456 (ABSM II-R).

Please send a receipt to lead associate, Hal Brostrom (address listed below).

Sincerely,



Hal J Brostrom
P O Bos 536
330 Box Elder Drive
Grantsville, UT 84029
Phone (435) 830-3932

MAINTENANCE FEE PAYMENT

Claimant Name: HAL BROSTROM

Address: P O BOX 536

City: GRANTSVILLE State: UT Zip: 84029

Telephone: 435-830-3932

E-mail address: hbrostrom@yahoo.com

Signature: *Hal Brostrom*

Check here if this is a change of address.

RECEIVED
BLM AZ STATE OFFICE
2019 AUG 23 P 3:02
PHOENIX, ARIZONA

BLM
Date
Stamp

LINE NO.	AMC NUMBER	CLAIM/SITE NAME	COUNTY RECORDER DATA (If available)	TWP	RNG	SEC
1	352455 345615	ABSM I-R ABST	Book 3709 page 511	10N	3W	31/24
2	352456 345616	ABSM II-R ABS II	Book 3709 page 512	10N	3W	13/24
3						
4						
5						
6						
7						
8						
9						
10						

List additional claims on Form MCF114.

Bureau of Land Management
Arizona State Office
www.blm.gov/az/

No. of Claims: 16 x \$165 = \$2,640

Check No: _____ Init. _____

Receipt No.: 4541894

For BLM Use Only

Form: MCF112
Revised July 2009

This form is available from the **Arizona Department of Mines and Mineral Resources** and may be reproduced.

Entered 9/4/19 AD

United States Department of the Interior
Bureau of Land Management
 DIV OF LANDS, MINRLS & ENERGY
 ONE N CENTRAL AVE
 PHOENIX, AZ 85004 -4427
 Phone: 602-417-9200

Receipt	
No:	4541894

Transaction #: 4662854	
Date of Transaction: 08/25/2019	
CUSTOMER:	
HAL J BROSTROM PO BOX 536 GRANTSVILLE, UT 84029-0536 US	

LINE #	QTY	DESCRIPTION	REMARKS	UNIT PRICE	TOTAL
1	1.00	LOCATABLE MINERALS / MINING CLAIMS- NOT NEW-UNADJUD, ONE AUTH NO. ONLY / MINING CLAIM MONEY RECEIVED CASES: AMC345615/\$2640.00	MAINT 2020/16	- n/a -	2640.00
TOTAL:					\$2,640.00

PAYMENT INFORMATION			
1	AMOUNT:	2640.00	POSTMARKED: N/A
	TYPE:	CHECK	RECEIVED: 08/23/2019
	CHECK NO:	4000470898	
	NAME:	BROSTROM, HAL J PO BOX 536 GRANTSVILLE UT 84029-0536 US	

REMARKS

This receipt was generated by the automated BLM Collections and Billing System and is a paper representation of a portion of the official electronic record contained therein.

Amc 352455

MAINTENANCE FEE PAYMENT

Claimant Name: HAL J BROSTROM
Address: P O BOX 536
City: GRANTSVILLE State: UT Zip: 84029
Telephone: 435-830-3932
E-mail address: hbrostrom@yahoo.com
Signature: _____

BLM Date Stamp	RECEIVED
	BLM AZ STATE OFFICE
	2010 AUG 23 P 2:34
PHOENIX, ARIZONA	

Check here if this is a change of address.

LINE NO.	AMC NUMBER	CLAIM/SITE NAME	COUNTY RECORDER DATA (If available)	TWP	RNG	SEC
1	352455	ABSM I-R	Book 3709 page 511	10 N	3W	13/24
2	352456	ABSM II-R	Book 3709 page 512	10 N	3W	13/24
3						
4						
5						
6						
7						
8						
9						
10						

List additional claims on Form MCF114.

No. of Claims*: <u>16</u> x \$155 = \$ <u>2,480.00</u>
Check No: _____ Init. _____
Receipt No.: <u>4245405</u>
For BLM Use Only

**Bureau of Land Management
Arizona State Office**
www.blm.gov/az/

* \$155 per lode mining claim, mill site, or tunnel site; and \$155 for each 20 acres or portion thereof for each placer mining claim.

ENTERED
AUG 29 2010
BY _____

Form: MCF112
Revised July 2014

August 21, 2018

Bureau of Land Management
Arizona State Office
One North Central Avenue – Suite 800
Phoenix, Arizona 85004-4427

RECEIVED
BLM AZ STATE OFFICE
2018 AUG 23 P 2:34
PHOENIX, ARIZONA

RE: MAINTENANCE FEE PAYMENTS

Enclosed you will find a cashier's check in amount of \$2,480 to cover annual mining claim maintenance fees for our Arizona Claims.

AMC Claims # 352455 (ABSM I-R) and # 352456 (ABSM II-R).

Please send a receipt to lead associate, Hal Brostrom (address listed below).

Sincerely,

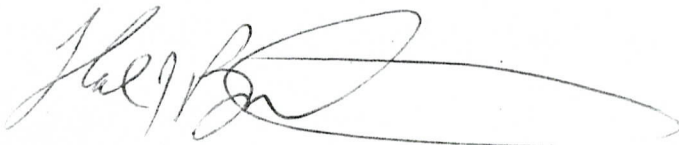

Hal J Brostrom

P O Bos 536





330 Box Elder Drive

Grantsville, UT 84029

Phone (435) 830-3932

PRESS FIRMLY TO :

PRIO
★ **MA**

-  DATE OF D
-  USPS TRAC
-  INSURANCI
-  PICKUP AVI

* Domestic onl

U.S. POSTAGE
PAID
GRANTSVILLE, UT
84029
AUG 21, 18
AMOUNT
\$6.70
R2305E124006-05



85004



1004

WHEN USED INTERNATIONALLY,
A CUSTOMS DECLARATION
LABEL MAY BE REQUIRED.

PS00001000014



PRESS FIRMLY TO SEAL

PRIORITY
★ **MAIL** ★



VISIT US AT USPS.COM
ORDER FREE SUPPLIES ONLINE

FROM:

HAL J. Brostrom
P.O. Box 536
GRANTSVILLE, UT
84029

TO:

Bureau of Land Management
Arizona State Office
ONE North Central - STE 800
85004-4427

PRIORITY MAIL
POSTAGE REQUIRED

RECEIVED
EPI4F JULY 2013/15 ZV M 18
OD: 12.5 x 9.5/11.333

2018 AUG 23 P 2:34
PHOENIX, ARIZONA

VISIT US AT USPS.COM
ORDER FREE SUPPLIES ONLINE

EXPECTED DELIVERY DAY: 08/23/2018
USPS TRACKING NUMBER



9505 5161 9021 8233 0991 16



Label 228, March 2016

FOR DOMESTIC AND INTERNATIONAL USE

PRIORITY[®]

★ MAIL ★



FLAT RATE ENVELOPE

ONE RATE ★ ANY WEIGHT*



PS00001000014

EP14F July 2013
OD: 12.5 x 9.5



United States Department of the Interior
Bureau of Land Management
 DIV OF LANDS, MINRLS & ENERGY
 ONE N CENTRAL AVE
 PHOENIX, AZ 85004 -4427
 Phone: 602-417-9200

Receipt

No: 4245665

Transaction #: 4361116	
Date of Transaction: 08/27/2018	
CUSTOMER:	
HAL J BROSTROM PO BOX 536 GRANTSVILLE, UT 84029-0536 US	

LINE #	QTY	DESCRIPTION	REMARKS	UNIT PRICE	TOTAL
1	1.00	LOCATABLE MINERALS / MINING CLAIMS- NOT NEW-UNADJUD, ONE AUTH NO. ONLY / MINING CLAIM MONEY RECEIVED CASES: AMC352455/\$2480.00	MAINT 2019	- n/a -	2480.00
TOTAL:					\$2,480.00

PAYMENT INFORMATION					
1	AMOUNT:	2480.00	POSTMARKED:	N/A	
	TYPE:	CHECK	RECEIVED:	08/23/2018	
	CHECK NO:	4000398586			
	NAME:	BROSTROM, HAL J PO BOX 536 GRANTSVILLE UT 84029-0536 US			

REMARKS

This receipt was generated by the automated BLM Collections and Billing System and is a paper representation of a portion of the official electronic record contained therein.

345615

352455

MAINTENANCE FEE PAYMENT

Claimant Name: HAL BROSTROM

Address: P O BOX 536

City: GRANTSVILLE State: UT Zip: 84029

Telephone: 435-830-3932

E-mail address: hbrostrom@yahoo.com

Signature: *Hal Brostrom*

Check here if this is a change of address.

RECEIVED
BLM AZ STATE OFFICE
2017 AUG 29 A 8:27
PHOENIX, ARIZONA

BLM
Date
Stamp

LINE NO.	AMC NUMBER	CLAIM/SITE NAME	COUNTY RECORDER DATA (If available)	TWP	RNG	SEC
1	345615	ABS I				
2	345616	ABS II				
3	345617	ABS III				
4	345618	ABS IV				
5	345619	ABS V				
6	345620	ABS VI				
7	345621	ABS VII				
8	345622	ABS VIII				
9	352455	ABSM I-R				
10	352456	ABSM II-R				

List additional claims on Form MCF114.

Bureau of Land Management
Arizona State Office
www.blm.gov/az/

No. of Claims: TEN (10) x \$140 = 12,800
 Check No: 4000333898 HWL
 Receipt No.: 3966166
 For BLM Use Only

Form: MCF112
Revised July 2009

This form is available from the Arizona Department of Mines and Mineral Resources and may be reproduced.

ENTERED
SEP 05 2017

PRESS FIRMLY TO SEAL

WHEN USED INTERNATIONALLY,
A CUSTOMS DECLARATION
LABEL MAY BE REQUIRED.



PRESS FIRMLY TO SEAL

2 TYVEK™ IS RECYCLABLE.
100% ©2013 DUPONT™ AND TYVEK™ ARE TRADEMARKS OF DUPONT.



PS1000000005

EP13C July 2013
OD: 11.625 x 15.125

VISIT US AT **USPS.COM**®
ORDER FREE SUPPLIES ONLINE



DuPont™ Tyvek®
Protect What's Inside.™

CUSTOMER USE ONLY

FROM: (PLEASE PRINT) PHONE ()

PAYMENT BY ACCOUNT (If applicable)

DELIVERY OPTIONS (Customer Use Only)

SIGNATURE REQUIRED Note: The mailer must check the "Signature Required" box if the mailer: 1) Requires the addressee's signature. OR 2) Purchases additional insurance. OR 3) Purchases COD service. OR 4) Purchases Return Receipt service. If the box is not checked, the Postal Service will leave the item in the addressee's mail receptacle or other secure location without attempting to obtain the addressee's signature on delivery.

Delivery Options

No Saturday Delivery (delivered next business day)

Sunday/Holiday Delivery Required (additional fee, where available)*

10:30 AM Delivery Required (additional fee, where available)*

*Refer to USPS.com or local Post Office for availability.

TO: (PLEASE PRINT) PHONE ()

ZIP+4® (U.S. ADDRESSES ONLY)
85004-4427

■ For pickup or USPS Tracking™, visit USPS.com or call 800-222-1811.
■ \$100.00 insurance included.



EL667735535US



**PRIORITY
MAIL
EXPRESS™**

ORIGIN (POSTAL SERVICE USE ONLY)

1-Day 2-Day Military DPO

PO ZIP Code Scheduled Delivery Date (MM/DD/YY) Postage \$

Date Accepted (MM/DD/YY) Scheduled Delivery Time Insurance Fee COD Fee

10:30 AM 3:00 PM

12 NOON

Time Accepted AM PM 10:30 AM Delivery Fee Return Receipt Fee Live Airmail Transportation Fee

Special Handling/Fragile Sunday/Holiday Premium Fee Total Postage & Fees \$

Weight Flat Rate Acceptance Employee Initials \$

DELIVERY (POSTAL SERVICE USE ONLY)

Delivery Attempt (MM/DD/YY) Time Employee Signature AM PM

Delivery Attempt (MM/DD/YY) Time Employee Signature AM PM

LABEL 11-6, OCTOBER 2016 PBN 7650-02-000-0000 3-ADDRESSEE COPY

★ MAIL ★
EXPRESS™
OUR FASTEST SERVICE IN THE U.S.

- USPS TRACKING™ INCLUDED
- INSURANCE INCLUDED
- PICKUP AVAILABLE
- SIGNATURE INCLUDED UPON REQUEST

* Money Back Guarantee to U.S., select APO/FPO/DPO, and select International destinations. See DMM and IMM at ps.usps.com for complete details.
† Money Back Guarantee for U.S. destinations only.

RECEIVED
BLM AZ STATE OFFICE
2017 AUG 29 A 8:27
PHOENIX, ARIZONA

1007

U.S. POSTAGE
PAID
GRANTSVILLE, UT
84029
AUG 25 17
AMOUNT
\$24.55
R2305E124006-10



Pieces Recycle
This packaging is the property of the U.S. Postal Service® and is provided solely for use in sending Priority Mail Express® shipments. Misuse may violate federal law. This packaging is not for resale. EPI3C © U.S. Postal Service July 2013. All rights reserved.

United States Department of the Interior
Bureau of Land Management
 DIV OF LANDS, MINRLS & ENERGY
 ONE N CENTRAL AVE
 PHOENIX, AZ 85004 -4427
 Phone: 602-417-9200

Receipt

No: 3966166

Transaction #: 4076048	
Date of Transaction: 08/30/2017	
CUSTOMER:	
HAL J BROSTROM PO BOX 536 GRANTSVILLE,UT 84029-0536 US	

LINE #	QTY	DESCRIPTION	REMARKS	UNIT PRICE	TOTAL
1	1.00	LOCATABLE MINERALS / MINING CLAIMS- NOT NEW-UNADJUD, ONE AUTH NO. ONLY / MINING CLAIM MONEY RECEIVED CASES: AMC345615/\$12400.00	MAINT 2018/10	- n/a -	12400.00
TOTAL:					\$12,400.00

PAYMENT INFORMATION					
1	AMOUNT:	12400.00	POSTMARKED:	08/25/2017	
	TYPE:	CHECK	RECEIVED:	08/29/2017	
	CHECK NO:	4000333298			
	NAME:	BROSTROM, HAL J PO BOX 536 GRANTSVILLE UT 84029-0536 US			

REMARKS

This receipt was generated by the automated BLM Collections and Billing System and is a paper representation of a portion of the official electronic record contained therein.

Run Date: 09/09/16

Run Time: 05:54 AM

**DEPARTMENT OF THE INTERIOR
BUREAU OF LAND MANAGEMENT
MINING CLAIMS**

MC Maintenance Fees Paid Through the BLM Pay Portal

CBS Receipt: 3643489

Printed For Lead File # **AMC352455**

Agency Tracking ID: 1472232656

Assessment Year: 2017

Number of BLM Serial Nr: 2

Paid On: 08/26/2016

Total Amount Paid: \$2,480.00

Claim Name	BLM Serial No	Lead File No	Amount Paid
ABSM-I-R	AMC352455	AMC352455	\$1,240.00
ABSM-II-R	AMC352456	AMC352455	\$1,240.00

United States Department of the Interior
Bureau of Land Management
 BUSINESS & SUPPORT SVCS DIV
 ONE N CENTRAL AVE SUITE 800
 PHOENIX, AZ 85004 -4427
 Phone: (602) 417-9200

Receipt

No: 3643489

Transaction #: 3747452	
Date of Transaction: 08/26/2016	
CUSTOMER:	
	HAL J BROSTROM P O BOX 536 GRANTSVILLE, UT 84029 US

LINE #	QTY	DESCRIPTION	REMARKS	UNIT PRICE	TOTAL
1	1.00	LOCATABLE MINERALS / MINING CLAIMS- NOT NEW-UNADJUD, ONE AUTH NO. ONLY / MINING CLAIM MONEY RECEIVED CASES: AMC352456/\$2480.00		- n/a -	2480.00
TOTAL:					\$2,480.00

PAYMENT INFORMATION			
NOTE: Items will appear on credit card statement as "BLM O Mining Claim".			
1	AMOUNT:	2480.00	POSTMARKED: N/A
	TYPE:	CREDIT CARD	RECEIVED: 08/26/2016
	NAME:	HAL J BROSTROM P O BOX 536 GRANTSVILLE UT 84029 US	
	CARD NO:	XXXXXXXXXXXX0689	AUTH CODE: 033300
	NAME ON CARD:	HAL J BROSTROM	
	EXPIRES:	02/2019	
	SIGNATURE:		

REMARKS

This receipt was generated by the automated BLM Collections and Billing System and is a paper representation of a portion of the official electronic record contained therein.

345615

352455

August 27, 2015

Sent via Federal Express

Bureau of Land Management
Arizona State Office
One North Central Avenue – Suite 800
Phoenix, Arizona 85004-4427

RE: MAINTENANCE FEE PAYMENTS

Enclosed you will find a check for \$12,400.00 issued to the Bureau of Land Management – Arizona, to cover the annual mining claim maintenance fees for our Arizona Claims. .

Claims #AMC 345615, 345616, 345617, 345318, 345619, 345620, 345621, 645622, 352455, 352456.

Claims names ABS I through VIII, ABSM I-R and ABSM II-R.

Please send the receipt to agent/associate Hal Brostrom (address listed below).

Sincerely,

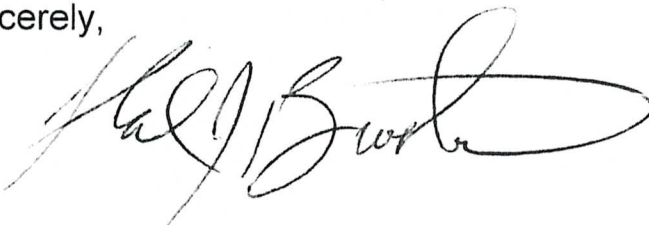

Hal J Brostrom
330 Box Elder Drive
Grantsville, UT 84029
Phone (435) 830-3932

PHOENIX, ARIZONA
2015 AUG 28 P 4: 02
RECEIVED
PLM

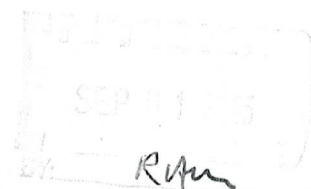

MAINTENANCE FEE PAYMENT

Claimant Name: HAL BROSTROM
 Address: P O BOX 536
 City: GRANTSVILLE State: UT Zip: 84029
 Telephone: 435-830-3932
 E-mail address: hbrostrom@yahoo.com

Signature: 

Check here if this is a change of address.

RECEIVED
 BLM ARIZONA OFFICE
 2015 AUG 28 P 4: 03
 PHOENIX, ARIZONA
 BLM
 Date
 Stamp

LINE NO.	AMC NUMBER	CLAIM/SITE NAME	COUNTY RECORDER DATA (If available)	TWP	RNG	SEC
1	345615	ABS I				
2	345616	ABS II				
3	345617	ABS III				
4	345618	ABS IV				
5	345619	ABS V				
6	345620	ABS VI				
7	345621	ABS VII				
8	345622	ABS VIII				
9	352455	ABSM I-R				
10	352456	ABSM II-R				

List additional claims on Form MCF114.

Bureau of Land Management
Arizona State Office
 www.blm.gov/az/

$\frac{1}{2}$ 12,400.00

No. of Claims: 10 x ¹⁵⁵ ~~\$140~~ = \$12400.00
 Check No: 400218913 Init. A.H.
 Receipt No.: 382068
For BLM Use Only

Form: MCF112
 Revised July 2009

PRESS FIRMLY TO SEAL

PRESS FIRMLY TO SEAL



1007

...VILLE, UT
04028
AUG 27, 15
AMOUNT
\$19.99
00123588-03

PRIORITY ★ MAIL ★ EXPRESS™

OUR FASTEST SERVICE IN THE U.S.

RECEIVED
BLM AZ STATE OFFICE
2015 AUG 28 P 4: 02
PHOENIX, ARIZONA

WHEN USED INTERNATIONALLY,
A CUSTOMS DECLARATION
LABEL MAY BE REQUIRED.



EP13F July 2013 OD: 12.5 x 9.5



PS10001000006

1A
1B

WRITE FIRMLY TO MAKE ALL COPIES LEGIBLE.

CUSTOMER USE ONLY

FROM: (PLEASE PRINT) PHONE (435) 930-3932
Hae J. Brustrom
P.O. Box 536
Glentville, UT 84029

PAYMENT BY ACCOUNT: (if applicable)

DELIVERY OPTIONS (Customer Use Only)

SIGNATURE REQUIRED Note: The mailer must check the "Signature Required" box if the mailer: 1) requires the addressee's signature; OR 2) Purchases additional insurance; OR 3) Purchases COD service; OR 4) purchases Return Receipt service. If the box is not checked, the Postal Service will leave the item in the addressee's mail receptacle or other secure location without attempting to obtain the addressee's signature on delivery.

Delivery Options

No Saturday Delivery (delivered next business day)
 Sunday/Holiday Delivery Required (additional fee, where available)
 10:30 AM Delivery Required (additional fee, where available)
 *Refer to USPS.com or local Post Office for availability.

TO: (PLEASE PRINT) PHONE ()
Bureau of Land Management
ARIZONA STATE OFFICE
ONE NORTH CENTRAL AVE. #800
PHOENIX, AZ

ZIP + 4® (U.S. ADDRESSES ONLY)
85004-4427

For pickup or USPS Tracking™, visit USPS.com or call 800-222-1811.
\$100.00 Insurance included.



EK604114804US



PRIORITY
★ MAIL ★
EXPRESS™

ORIGIN (POSTAL SERVICE USE ONLY)

1-Day 2-Day Military DPO

PO ZIP Code 84029	Scheduled Delivery Date (MM/DD/YY) 8-28-15	Postage \$ 19.99
Date Accepted (MM/DD/YY) 8-27-15	Scheduled Delivery Time <input type="checkbox"/> 10:30 AM <input checked="" type="checkbox"/> 3:00 PM <input type="checkbox"/> 12 NOON	Insurance Fee \$
Time Accepted 12:47	10:30 AM Delivery Fee <input type="checkbox"/> AM <input checked="" type="checkbox"/> PM	Return Receipt Fee \$
Weight lbs. 1 ozs.	Sunday/Holiday Premium Fee \$	Live Animal Transportation Fee \$
	Acceptance Employee Initials DM	Total Postage & Fees \$ 19.99

DELIVERY (POSTAL SERVICE USE ONLY)

Delivery Attempt (MM/DD/YY) Time	Employee Signature
<input type="checkbox"/> AM <input type="checkbox"/> PM	
Delivery Attempt (MM/DD/YY) Time	Employee Signature
<input type="checkbox"/> AM <input type="checkbox"/> PM	

LABEL 11-B, JANUARY 2014 PSN 7690-02-000-9996 3-ADDRESSEE COPY

destinations. See DMM and IMM at pe.usps.com for complete details.

+ Money Back Guarantee for U.S. destinations only.

VISIT US AT USPS.COM®
ORDER FREE SUPPLIES ONLINE



UNITED STATES
POSTAL SERVICE.

This packaging is the property of the U.S. Postal Service® and is provided solely for use in sending Priority Mail Express™ shipments. Misuse may be a violation of federal law. This packaging is not for resale. EP13F © U.S. Postal Service, July 2013. All rights reserved.

United States Department of the Interior
Bureau of Land Management
 LANDS/RECREATION & PLANNING
 ONE N CENTRAL AVE
 PHOENIX, AZ 85004 -2203
 Phone: 602-417-9200

Receipt

No: 3382068

Transaction #: 3480383	
Date of Transaction: 08/31/2015	
CUSTOMER:	
HAL J BROSTROM PO BOX 536 GRANTSVILLE, UT 84029-0536 US	

LINE #	QTY	DESCRIPTION	REMARKS	UNIT PRICE	TOTAL
1	1.00	LOCATABLE MINERALS / MINING CLAIMS-NOT NEW-UNADJUD, ONE AUTH NO. ONLY / MINING CLAIM MONEY RECEIVED CASES: AMC345615/\$12400.00	MAINT FEE PYMNT - 10 2016	- n/a -	12400.00
TOTAL:					\$12,400.00

PAYMENT INFORMATION			
1	AMOUNT:	12400.00	POSTMARKED: 08/27/2015
	TYPE:	CHECK	RECEIVED: 08/28/2015
	CHECK NO:	4000218913	
	NAME:	BROSTROM, HAL J PO BOX 536 GRANTSVILLE UT 84029-0536 US	

REMARKS

This receipt was generated by the automated BLM Collections and Billing System and is a paper representation of a portion of the official electronic record contained therein.

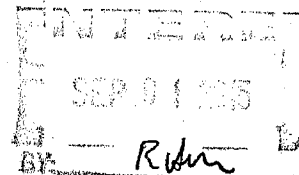

8/31/2015

345615
352455

MAINTENANCE FEE PAYMENT

Claimant Name: HAL J BROSTROM
 Address: P O BOX 536
 City: GRANTSVILLE State: UT Zip: 84029
 Telephone: 435-884-1400
 E-mail address: hbrostrom@yahoo.com
 Signature: *Hal Brostrom*

RECEIVED
 BLM AZ STATE OFFICE
 PHOENIX, ARIZONA
 2014 AUG 21 P 2:39
 BLM
 Date
 Stamp

Check here if this is a change of address.

LINE NO.	AMC NUMBER	CLAIM/SITE NAME	COUNTY RECORDER DATA (If available)	TWP	RNG	SEC
1	345615	ABS I				
2	345616	ABS II				
3	345617	ABS III				
4	345618	ABS IV				
5	345619	ABS V				
6	345620	ABS VI				
7	345621	ABS VII				
8	345622	ABS VIII				
9	352455	ABSM I-R	BOOK 3709 Page 511			
10	352456	ABSM II-R	BOOK 3709 Page 512			

List additional claims on Form MCF114.

Bureau of Land Management
Arizona State Office
www.blm.gov/az/

No. of Claims: TEN (10) x \$140 = 12,400.00
 Check No: C/C Init. AA
 Receipt No.: 3109063
 For BLM Use Only

Form: MCF112
 Revised July 2009

This form is available from the **Arizona Department of Mines and Mineral Resources** and may be reproduced.

RECEIVED
 AUG 27 2014
 RE

Quantum Science, LC

2936 Sierra Point Place
Salt Lake City, UT 84109
Telephone (801) 906-0370

August 19, 2014

Sent via Federal Express

Bureau of Land Management

Arizona State Office

One North Central Avenue – Suite 800

Phoenix, Arizona 85004-4427

RE: MAINTENANCE FEE PAYMENTS

RECEIVED
BLM/ARIZONA STATE OFFICE
2014 AUG 21 P 2:39
PHOENIX, ARIZONA

Enclosed you will find a check for \$12,400.00 issued to the Bureau of Land Management – Arizona, to cover the annual mining claim maintenance fees for our Arizona Claims. .

Claims #AMC 345615, 345616, 345617,345318, 345619, 345620, 345621, 645622, 352455, 352456.

Claims names ABS I through VIII, ABSM I-R and ABSM II-R.

Please send the receipt to agent/associate Hal Brostrom (address listed below).

Sincerely,

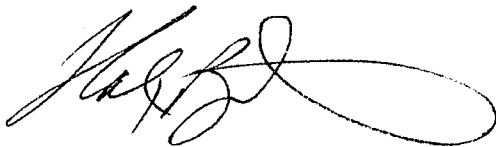

Hal J Brostrom

330 Box Elder Drive

Grantsville, UT 84029

Phone (435) 830-3932

Cc: Emanuel A Floor, Jerry D Newman, et al

United States Department of the Interior
Bureau of Land Management
 LANDS/RECREATION & PLANNING
 ONE N CENTRAL AVE
 PHOENIX, AZ 85004 -2203
 Phone: 602-417-9200

Receipt

No: 3109063

Transaction #: 3200748	
Date of Transaction: 08/22/2014	
CUSTOMER:	
HAL J BROSTROM PO BOX 536 GRANTSVILLE, UT 84029-0536 US	

LINE #	QTY	DESCRIPTION	REMARKS	UNIT PRICE	TOTAL
1	1.00	LOCATABLE MINERALS / MINING CLAIMS-NOT NEW-UNADJUD, ONE AUTH NO. ONLY / MINING CLAIM MONEY RECEIVED CASES: AMC345615/\$12400.00	MAINT FEE PYMNT (10) 2015	- n/a -	12400.00
TOTAL:					\$12,400.00

PAYMENT INFORMATION					
1	AMOUNT:	12400.00	POSTMARKED:	08/19/2014	
	TYPE:	CHECK	RECEIVED:	08/21/2014	
	CHECK NO:	4000159187			
	NAME:	BROSTROM, HAL J PO BOX 536 GRANTSVILLE UT 84029-0536 US			

REMARKS

This receipt was generated by the automated BLM Collections and Billing System and is a paper representation of a portion of the official electronic record contained therein.

AMC 352455
AMC 345615

MAINTENANCE FEE PAYMENT

Claimant Name: Hal J. Brostrom
 Address: P.O. Box 536
 City: GRANTSVILLE State: UT Zip: 84029
 Telephone: (435) 884-1400
 E-mail address: hbrostrom@yahoo.com
 Signature: *Hal J. Brostrom*
 Check here if this is a change of address.

RECEIVED
BLM AZ STATE OFFICE
2013 AUG 29 A 9:47
PHOENIX, ARIZONA
BLM Date Stamp

LINE NO.	AMC NUMBER	CLAIM/SITE NAME	COUNTY RECORDER DATA (If available)	TWP	RNG	SEC
1	345615	ABS I				
2	345616	ABS II				
3	345617	ABS III				
4	345618	ABS IV				
5	345619	ABS V				
6	345620	ABS VI				
7	345621	ABS VII				
8	345622	ABS VIII				
9	352455	ABSm I-R	Book 3709 Page 511			
10	352456	ABSm II-R	Book 3709 Page 512			

RECEIVED
BLM AZ STATE OFFICE
2013 AUG 29 A 9:48
PHOENIX, ARIZONA

List additional claims on Form MCF114.

Bureau of Land Management
Arizona State Office
www.blm.gov/az/

No. of Claims: ten x \$140 = \$ 11,200
 Check No.: 400091638 Init. 1120 [Signature]
 Receipt No.: 2870/22
 For BLM Use Only

Form: MCF112
Revised July 2009

This form is available for the Arizona Department of Mines and Mineral Resources and may be reproduced.

ENTERED
SEP 06 2013
BY: TS

Quantum Science, LC

2936 Sierra Point Place
Salt Lake City, UT 84109
Telephone (801) 906-0370

August 28, 2013

Sent via Federal Express

Bureau of Land Management

Arizona State Office

One North Central Avenue – Suite 800

Phoenix, Arizona 85004-4427

RE: MAINTENANCE FEE PAYMENTS

Enclosed you will find a check for \$11,200.00 issued to the Bureau of Land Management – Arizona, to cover the annual mining claim maintenance fees for our Arizona Claims. .

Claims #AMC 345615, 345616, 345617,345318, 345619, 345620, 345621, 645622, 352455, 352456.

Claims names ABS I through VIII, ABSM I-R and ABSM II-R.

Please send the receipt to agent/associate Hal Brostrom (address listed below).

Sincerely,



Hal J Brostrom

330 Box Elder Drive

Grantsville, UT 84029

Phone (435) 830-3932

RECEIVED
BLM AZ STATE OFFICE
2013 AUG 29 A 9:47
PHOENIX, ARIZONA

Cc: George Klinell, Emanuel A Floor, Jerry D Newman, et al

From: (435) 249-0540
Jill Thomas
Digidocs
225 E Main St Ste F
Grantsville, UT 84029

Origin ID: SLCA



Ship Date: 28AUG13
ActWgt: 1.0 LB
CAD: 100065485/NET3430

Delivery Address Bar Code



SHIP TO: (435) 249-1454
Arizona State Office
Bureau of Land Management
1 N CENTRAL AVE
STE 800
PHOENIX, AZ 85004

BILL SENDER

Ref # Hal Brostrom
Invoice #
PO #
Dept #

THU - 29 AUG 10:30A
PRIORITY OVERNIGHT

TRK# 7965 6544 1615
0201

85004
AZ-US
PHX

WP ZSYA



51A0109B91A5E

After printing this label:

1. Use the 'Print' button on this page to print your label to your laser or inkjet printer.
2. Fold the printed page along the horizontal line.
3. Place label in shipping pouch and affix it to your shipment so that the barcode portion of the label can be read and scanned.

Warning: Use only the printed original label for shipping. Using a photocopy of this label for shipping purposes is fraudulent and could result in additional billing charges, along with the cancellation of your FedEx account number. Use of this system constitutes your agreement to the service conditions in the current FedEx Service Guide, available on fedex.com. FedEx will not be responsible for any claim in excess of \$100 per package, whether the result of loss, damage, delay, non-delivery, misdelivery, or misinformation, unless you declare a higher value, pay an additional charge, document your actual loss and file a timely claim. Limitations found in the current FedEx Service Guide apply. Your right to recover from FedEx for any loss, including intrinsic value of the package, loss of sales, income interest, profit, attorney's fees, costs, and other forms of damage whether direct, incidental, consequential, or special is limited to the greater of \$100 or the authorized declared value. Recovery cannot exceed actual documented loss. Maximum for items of extraordinary value is \$1,000, e.g. jewelry, precious metals, negotiable instruments and other items listed in our ServiceGuide. Written claims must be filed within strict time limits, see current FedEx Service Guide.

United States Department of the Interior
Bureau of Land Management
 LANDS/RECREATION & PLANNING
 ONE N CENTRAL AVE
 PHOENIX, AZ 85004 -2203
 Phone: 602-417-9200

Receipt

No: 2870122

Transaction #: 2956093	
Date of Transaction: 08/30/2013	
CUSTOMER:	
HAL J BROSTROM PO BOX 536 GRANTSVILLE, UT 84029-0536 US	

LINE #	QTY	DESCRIPTION	REMARKS	UNIT PRICE	TOTAL
1	1.00	LOCATABLE MINERALS / MINING CLAIMS-NOT NEW-UNADJUD, ONE AUTH NO. ONLY / MINING CLAIM MONEY RECEIVED CASES: AMC345615/\$11200.00	MAINT FEE PYMNT (10) 2014	- n/a -	11200.00
TOTAL:					\$11,200.00

PAYMENT INFORMATION					
1	AMOUNT:	11200.00	POSTMARKED:	08/29/2013	
	TYPE:	CHECK	RECEIVED:	08/29/2013	
	CHECK NO:	4000096638			
	NAME:	BROSTRAM, HAL J PO BOX 536 GRANTSVILLE UT 84029-0536 US			

REMARKS

This receipt was generated by the automated BLM Collections and Billing System and is a paper representation of a portion of the official electronic record contained therein.

Quantum Science, LC

2936 Sierra Point Place
Salt Lake City, UT 84109
Telephone (801) 906-0370

Amc 345615
Amc 352455

August 15, 2012

Sent via Federal Express

Bureau of Land Management

Arizona State Office

One North Central Avenue – Suite 800

Phoenix, Arizona 85004-4427

RECEIVED
BLM AZ STATE OFFICE
2012 AUG 20 A 10: 20
PHOENIX, ARIZONA

RE: MAINTENANCE FEE PAYMENTS

Enclosed you will find a check for \$1400.00 issued to the Bureau of Land Management – Arizona, to cover annual mining claim maintenance fees for Utah Claims #AMC 345615, 345616, 345617, 345318, 345619, 345620, 345621, 645622, 352455, 352456. Claims names ABS I through VIII, ABSM I-R and ABSM II-R.

We understand that the BLM has issued an interim final rule regarding placer mining claim maintenance fees and that that changes in the fees assessed will be made upon final action by the BLM. Pursuant to the BLM website advisory and our conversation with a BLM employee, we are paying the old fees now.

It is understood that we will have sufficient time to (A) pay the new fees as required, and/or (B) reduce the size of our claims, paying the portion thereof.

If you have any questions, please contact Emanuel Floor at (801) 906-0370.

Please send the receipt to me at my address below.

Sincerely,

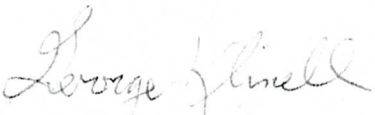

George Klinell, Lead Agent

2936 Sierra Point Place

Salt Lake City, UT 84109

MAINTENANCE FEE PAYMENT

Claimant Name: George Klinell
 Address: 2936 Sierra Point Place
 City: Salt Lake State: UT Zip: 84109
 Telephone: 801-566-1886
 E-mail address: eafloor@msn.com
 Signature: George Klinell

Check here if this is a change of address.

RECEIVED
 BLM AZ STATE OFFICE
 PHOENIX, ARIZONA
 2012 AUG 20 A 10:20
 BLM
 Date
 Stamp

LINE NO.	AMC NUMBER	CLAIM/SITE NAME	COUNTY RECORDER DATA (If available)	TWP	RNG	SEC
160 1	345615	ABS I				
160 2	345616	ABS II				
160 3	345617	ABS III				
160 4	345618	ABS IV				
160 5	345619	ABS V				
160 6	345620	ABS VI				
160 7	345621	ABS VII				
160 8	345622	ABS VIII				
160 9	352455	ABSM I-R				
160 10	352456	ABSM II-R				

List additional claims on Form MCF114.

Bureau of Land Management
 Arizona State Office
 www.blm.gov/az/

No. of Claims: ten x \$140 = \$1,400.00
 Check No: 400026055 Init. AKH
 Receipt No.: 2635520
 For BLM Use Only

Form: MCF112
 Revised July 2009

This form is available from the Arizona Department of Mines and Mineral Resources and may be reproduced.

$11,200 \times 10 = 112,000$
 $112,000 - 1,400 = 110,600$
~~110,600~~
 Pd \$9,800
 11/28/12 AT

ENTERED INTO COMPUTER
 9/2/12 AT

From: (435) 249-0540
Jill Thomas
Digidos
225 E Main St Ste F
Grantsville, UT 84020

Origin ID: SLCA



Ship Date: 17AUG12
ActlWgt: 1.0 LB
CAD: 100065485/INNET3300

Delivery Address Bar Code



SHIP TO: (435) 884-1400
Arizona State Office
Bureau of Land Management
1 N CENTRAL AVE
STE 800
PHOENIX, AZ 85004

BILL SENDER

Ref #
Invoice #
PO #
Dept #

Brostron

MON - 20 AUG A1
STANDARD OVERNIGHT

TRK# 7987 7028 8800
0201

85004
AZ-US
PHX

WP ZSYA

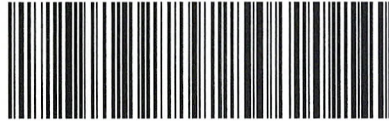

515G200C34AA44

RECEIVED
BLM AZ STATE OFFICE
2012 AUG 20 A 10: 20
PHOENIX, ARIZONA

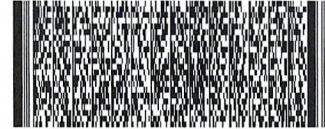

After printing this label:

1. Use the 'Print' button on this page to print your label to your laser or inkjet printer.
2. Fold the printed page along the horizontal line.
3. Place label in shipping pouch and affix it to your shipment so that the barcode portion of the label can be read and scanned.

Warning: Use only the printed original label for shipping. Using a photocopy of this label for shipping purposes is fraudulent and could result in additional billing charges, along with the cancellation of your FedEx account number. Use of this system constitutes your agreement to the service conditions in the current FedEx Service Guide, available on fedex.com. FedEx will not be responsible for any claim in excess of \$100 per package, whether the result of loss, damage, delay, non-delivery, misdelivery or misinformation, unless you declare a higher value, pay an additional charge, document your actual loss and file a timely claim. Limitations found in the current FedEx Service Guide apply. Your right to recover from FedEx for any loss, including intrinsic value of the package, loss of sales, income interest, profit, attorney's fees, costs, and other forms of damage whether direct, incidental, consequential, or special is limited to the greater of \$100 or the authorized declared value. Recovery cannot exceed actual documented loss. Maximum for items of extraordinary value is \$500, e.g. jewelry, precious metals, negotiable instruments and other items listed in our ServiceGuide. Written claims must be filed within strict time limits, see current FedEx Service Guide.



For FedEx Express® Shipments Only

Contents should be compatible with the container and packed securely. For

Page 1 of 1

Extremely

Insert
airbill
here

From: (435) 249-6540
Jill Thomas
Digitales
225 E Main St Ste F
Grantville, UT 84029

Origin ID: SLCA



Ship Date: 17AUG12
ActWgt: 1.0 LB
CAZ: 100065485/NET3300

Delivery Address Bar Code



Ref # Broken
Invoice #
PO #
Dept #

SHIP TO: (435) 284-1488
Arizona State Office
Bureau of Land Management
1 N CENTRAL AVE
STE 500
PHOENIX, AZ 85004

BILL SENDER

TRX# 7987 7028 8800
EZ#1

MON - 20 AUG A1
STANDARD OVERNIGHT

WP ZSYA

85004
AZ-UR
PHX



51022C2MR4M



2012 AUG 20 A 10:20
PHOENIX, ARIZONA

RECEIVED
BLM AZ STATE OFFICE

After printing this label:

1. Use the 'Print' button on this page to print your label to your laser or inkjet printer.
2. Fold the printed page along the horizontal line.
3. Place label in shipping pouch and affix it to your shipment so that the barcode portion of the label can be read and scanned.

Warning: Use only the printed original label for shipping. Using a photocopy of this label for shipping purposes is fraudulent and could result in additional billing charges, along with the cancellation of your FedEx account number. Use of this system constitutes your agreement to the service conditions in the current FedEx Service Guide, available on fedex.com. FedEx will not be responsible for any claim in excess of \$100 per package, whether the result of loss, damage, delay, non-delivery, misdelivery or misinformation, unless you declare a higher value, pay an additional charge, document your actual loss and file a timely claim. Limitations found in the current FedEx Service Guide apply. Your right to recover from FedEx for Recovery cannot exceed actual documented loss. Maximum for items of extraordinary value is \$500, e.g. jewelry, precious metals, negotiable instruments and other items listed in our Service Guide. Written claims must be filed within strict time limits, see current FedEx Service Guide.

United States Department of the Interior
Bureau of Land Management
 LANDS/RECREATION & PLANNING
 ONE N CENTRAL AVE
 PHOENIX, AZ 85004 -2203
 Phone: 602-417-9200

Receipt

No: 2635520

Transaction #: 2716091	
Date of Transaction: 08/21/2012	
CUSTOMER:	
GEORGE KLINELL 2936 SIERRA POINT PL SALT LAKE CITY, UT 84109-1944 US	

LINE #	QTY	DESCRIPTION	REMARKS	UNIT PRICE	TOTAL
1	1.00	LOCATABLE MINERALS / MINING CLAIMS-NOT NEW-UNADJUD, ONE AUTH NO. ONLY / MINING CLAIM MONEY RECEIVED CASES: AMC345615/\$1400.00	MAINT FEE PYMNT (10) 2013	- n/a -	1400.00
TOTAL:					\$1,400.00

PAYMENT INFORMATION			
1	AMOUNT:	1400.00	POSTMARKED: N/A
	TYPE:	CHECK	RECEIVED: 08/20/2012
	CHECK NO:	4000026055	
	NAME:	KLINELL, GEORGE 2936 SIERRA POINT PL SALT LAKE CITY UT 84109-1944 US	

REMARKS

This receipt was generated by the automated BLM Collections and Billing System and is a paper representation of a portion of the official electronic record contained therein.



Quantum Science, LC

2936 Sierra Point Place
Salt Lake City, UT 84109
Telephone (801) 906-0370

November 27, 2012

Sent via Federal Express

Bureau of Land Management
Arizona State Office – Attn: Amy Thrower
One North Central Avenue – Suite 800
Phoenix, Arizona 85004-4427

RECEIVED
BLM AZ STATE OFFICE
2012 NOV 28 A 9:35
PHOENIX, ARIZONA

RE: MAINTENANCE FEE PAYMENTS

Enclosed you will find a check for \$9,800.00 issued to the Bureau of Land Management – Arizona, to cover the balance of the annual mining claim maintenance fees for our Arizona Claims.

Claims #AMC 345615, 345616, 345617, 345318, 345619, 345620, 345621, 645622, 352455, 352456.

Claims names ABS I through VIII, ABSM I-R and ABSM II-R.

Please send the receipt to lead agent George Klinell. His mailing address is 2936 Sierra Point Place, Salt Lake City, UT 84109

Sincerely,

Hal J Brostrom

330 Box Elder Drive

Grantsville, UT 84029

Ph (435) 830-3932

Cc: George Klinell, Emanuel A Floor, Jerry D Newman, et al

NO. OF CLAIMS
AMOUNT \$9800.00
RECEIPT NO. 2697942
INIT. GKF

** BLM-ASO**

BLM-ASO COMPUTER

11/30/12 AT



United States Department of the Interior

BUREAU OF LAND MANAGEMENT

Arizona State Office

One North Central Avenue, Suite 800

Phoenix, Arizona 85004-4427

www.blm.gov/az/

OCT 31 2012



TAKE PRIDE
IN AMERICA

PHOENIX, ARIZONA

NOV 28 A 9:35

RECEIVED
BLM AZ STATE OFFICE

In Reply Refer To:
3800 (9310) AT
AMC345615, AMC352455

CERTIFIED MAIL – RETURN RECEIPT REQUEST 7011 2970 0002 3234 9402

NOTICE

KLINELL GEORGE, ET AL
2936 SIERRA POINT PLACE
SALT LAKE CITY, UT 84109

This Notice Affects Those Claims
Shown in the Block Below.

AMC345615 - 345622, 352455, 352456
ABS-I - VIII, ABSM I-R, II-R

2013 Maintenance Fees - Additional Fees Required

Your maintenance fee payment for the 2013 assessment year, in the amount of \$140 per claim, for the placer claims listed above, has been received and is insufficient. **The total due on your claim(s) is: \$9800.**

In accordance with the Consolidated Appropriations Act of 2012, Public Law 112-74 (125 Stat 1047), and FR44155-44158 (2012) Congress changed the way maintenance fees for placer mining claims are assessed. Instead of charging the maintenance fee on a per-claim basis, Congress stated that the fee, which is currently \$140, will be assessed on each 20 acre parcel of a placer claim or portion thereof.

Insufficient payment of the annual maintenance fee for the 2013 assessment year is a curable defect. **Therefore you are required to do one of the following within 30 days of receipt of this notice or your claim(s) will be declared forfeited:** 1) submit additional fees of \$140 per 20-acres or portion thereof based on the full acreage of the claim, or 2) amend the claim(s) to reduce the acres so a lesser fee is due and submit any additional fees due; or 3) relinquish the claim(s) in their entirety, in which case BLM will refund the maintenance fees you have already paid for the 2013 assessment year.

If you choose to amend the claims to reduce the acres, you must submit an amended location notice for each claim, with an accurate description and dimensions of the reduced claim, along with a map depicting the reduced claim, and a \$10 processing fee per amendment. An amendment must also be recorded at the county. If the amended claim contains more than 20 acres, calculate the additional fees due and submit those fees with the amendment(s).

Please include your Arizona Mining Claim (AMC) serial number(s) and claim name(s) when submitting the additional fees, and note that you are paying additional fees due. If additional information is required, please contact Amy Thrower at 602-417-9334.

Rebecca Heick

Rebecca Heick
Group Administrator
Lands and Minerals

RECEIVED
BLM AZ STATE OFFICE
2012 NOV 28 A 9:35
PHOENIX, ARIZONA

United States Department of the Interior
Bureau of Land Management
 LANDS/RECREATION & PLANNING
 ONE N CENTRAL AVE
 PHOENIX, AZ 85004 -2203
 Phone: 602-417-9200

Receipt

No:

2697942

Transaction #: 2779789	
Date of Transaction: 11/29/2012	
CUSTOMER:	
GEORGE KLINELL 2936 SIERRA POINT PL SALT LAKE CITY, UT 84109-1944 US	

LINE #	QTY	DESCRIPTION	REMARKS	UNIT PRICE	TOTAL
1	1.00	LOCATABLE MINERALS / MINING CLAIMS-NOT NEW-UNADJUD, ONE AUTH NO. ONLY / MINING CLAIM MONEY RECEIVED CASES: AMC345615/\$9800.00	ADDITIONAL MONIES FOR MAINT FEE PYMNT 2013	- n/a -	9800.00
TOTAL:					\$9,800.00

PAYMENT INFORMATION			
1	AMOUNT:	9800.00	POSTMARKED: 11/27/2012
	TYPE:	CHECK	RECEIVED: 11/28/2012
	CHECK NO:	4000045046	
	NAME:	BROSTROM, HAL J 2936 SIERRA POINT PL SALT LAKE CITY UT 84109-1944 US	

REMARKS

This receipt was generated by the automated BLM Collections and Billing System and is a paper representation of a portion of the official electronic record contained therein.

AMC 345615

AMC 352455

MAINTENANCE FEE PAYMENT

Claimant Name: GEORGE KLINELL
 Address: @2936 SIERRA POINT PLACE
 City: SALT LAKE State: UTAH Zip: 84109
 Telephone: 801-566-1886
 E-mail address: EAFLOOR@MSN.COM
 Signature: *George Klinell*

Check here if this is a change of address.

RECEIVED
 BLM AZ STATE OFFICE
 2011 AUG 30 A 7:39
 PHOENIX, AZ
 BLM
 Date
 Stamp

LINE NO.	AMC NUMBER	CLAIM/SITE NAME	COUNTY RECORDER DATA (If available)	TWP	RNG	SEC
1	345615	ABS I				
2	345616	ABS II				
3	345617	ABS III				
4	345618	ABS IV				
5	345619	ABS V				
6	345620	ABS VI				
7	345621	ABS VII				
8	345622	ABS VIII				
9	352455	ABSM I-R				
10	352456	ABSM II-R				

List additional claims on Form MCF114.

Bureau of Land Management
Arizona State Office
www.blm.gov/az/

SEP 7 2011
cm

No. of Claims: Ten x \$140 = 1,400.00
 Check No: _____ Init. *SK*
 Receipt No.: 2119408
 For BLM Use Only

Form: MCF112
Revised July 2009

This form is available from the Arizona Department of Mines and Mineral Resources and may be reproduced.

Quantum Science, LC
2936 Sierra Point Place
Salt Lake City, Utah 84109
Telephone (801) 906-0370

August 22, 2011

Via Express Mail

Bureau of Land Management USDI
Arizona State Office
One North Central Avenue - Suite 800
Phoenix, Arizona 85004-4427

RE: Maintenance Fee Payments

Enclosed you will find an official check for \$1,400.00 issued to Bureau of Land Management - Arizona to cover annual Mining Claim Maintenance fees for Arizona BLM Claims AMC 345615-622. Claim names ABS I through ABS VIII and Arizona Claims AMC 352455-456, Claim Names ABSM I-R and ABSM II-R

Should you have any questions you may contact Emanuel Floor at the above address and telephone number.

Please send the receipt to me at the address

Sincerely

George Klinell
Lean Agent

RECEIVED
BLM, AZ STATE OFFICE
2011 AUG 30 A 7:39
PHOENIX, AZ

United States Department of the Interior
Bureau of Land Management
 LANDS/RECREATION & PLANNING
 ONE N CENTRAL AVE
 PHOENIX, AZ 85004 -2203
 Phone: 602-417-9200

Receipt

No: 2419402

Transaction #: 2494822	
Date of Transaction: 08/30/2011	
CUSTOMER:	
GEORGE KLINELL 2936 SIERRA POINT PL SALT LAKE CITY, UT 84109-1944 US	

LINE #	QTY	DESCRIPTION	REMARKS	UNIT PRICE	TOTAL
1	1.00	LOCATABLE MINERALS / MINING CLAIMS-NOT NEW-UNADJUD, ONE AUTH NO. ONLY / MINING CLAIM MONEY RECEIVED CASES: AMC345615/\$1400.00	MAINT-10	- n/a -	1400.00
TOTAL:					\$1,400.00

PAYMENT INFORMATION					
1	AMOUNT:	1400.00	POSTMARKED:	08/26/2011	
	TYPE:	CHECK	RECEIVED:	08/30/2011	
	CHECK NO:	100924026			
	NAME:	QUANTUM SCIENCE 2936 SIERRA POINT PL SALT LAKE CITY UT 84109-1944 US			

REMARKS

This receipt was generated by the automated BLM Collections and Billing System and is a paper representation of a portion of the official electronic record contained therein.

**Quantum Science LC
2936 Sierra Point Place
Salt Lake City, Utah 84109
Telephone (801) 906-0370**

AMC 345615

352455

August 18, 2010
Salt Lake City, Utah

Via Express Mail

Bureau of Land Management - USDI
Arizona State Office
One North Central Avenue - Suite 800
Phoenix Arizona 85004-4427

Re: Maintenance Fee Payments

Gentlemen

Enclosed you will find an official check for \$1,400.00 issued to Bureau of Land Management - Arizona to cover annual Mining Claim Maintenance fees for Arizona BLM Claims #AMC 345615-622, Claim names ABS I through ABS VIII and Arizona Claims # AMC 352455-456, Claim names ABSM-I-R and ABSM-II-R.

Should you have any questions you may contact Emanuel Floor at the above address and telephone number.

Please send the receipt to me at the above address.

Sincerely

George Klinell
Lead Agent

PHOENIX, ARIZONA

2010 AUG 23 A 8:36

RECEIVED
BLM AZ STATE OFFICE

MAINTENANCE FEE PAYMENT

Claimant Name: GEORGE KLINELL
 Address: 2936 SIERRA POINT PLACE
 City: Salt Lake State: UT Zip: 84109-1944
 Telephone: (801) 566-1886
 E-mail address: eafloor@msn.com
 Signature: *George Klinell*

Check here if this is a change of address.

RECEIVED
 BLM AZ STATE OFFICE
 2010 AUG 23 A 8:37
 PHOENIX, ARIZONA
 BLM
 Date
 Stamp

LINE NO.	AMC NUMBER	CLAIM/SITE NAME	COUNTY RECORDER DATA (If available)	TWP	RNG	SEC
1	345615	ABS I				
2	345616	ABS II				
3	345617	ABS III				
4	345618	ABS IV	ENTERED INTO COMPUTER SEP 02 2010			
5	345619	ABS V				
6	345620	ABS VI				
7	345621	ABS VII				
8	345622	ABS VIII				
9	352455	ABSM I-R				
10	352456	ABSM II-R				

List additional claims on Form MCF114.

Bureau of Land Management
 Arizona State Office
 www.blm.gov/az/

No. of Claims: ten x \$140 \$1,400.00
 Check No: 1000286849 Init. ERG
 Receipt No.: 2197655
For BLM Use Only

Form: MCF112
 Revised July 2009

This form is available from the Arizona Department of Mines and Mineral Resources and may be reproduced.

**United States Department of the Interior
Bureau of Land Management
LANDS/RECREATION & PLANNING
ONE N CENTRAL AVE
PHOENIX, AZ 85004 -2203
Phone:**

Receipt

No: 2197655

Transaction #: 2267526		ENTERED INTO COMPUTER SEP 02 2010
Date of Transaction: 08/23/2010		
CUSTOMER:	QUANTUM SCIENCE 2936 SIERRA POINT PL SALT LAKE CITY,UT 84109-1944 US	

LINE #	QTY	DESCRIPTION	REMARKS	UNIT PRICE	TOTAL
1	1.00	LOCATABLE MINERALS / MINING CLAIMS- NOT NEW-UNADJUD,ONE AUTH NO. ONLY / MINING CLAIM MONEY RECEIVED CASES: AMC345615/\$1400.00	2011 MAINT (10)	- n/a -	1400.00
TOTAL:					\$1,400.00

PAYMENT INFORMATION			
1	AMOUNT:	1400.00	POSTMARKED: N/A
	TYPE:	CHECK	RECEIVED: 08/23/2010
	CHECK NO:	1000286849	
	NAME:	QUANTUM SCIENCE 2936 SIERRA POINT PL SALT LAKE CITY UT 84109-1944 US	

REMARKS	

This receipt was generated by the automated BLM Collections and Billing System and is a paper representation of a portion of the official electronic record contained therein.

AMC 345615
 AMC 352455

MAINTENANCE FEE PAYMENT

Claimant Name: George Klinell
 Address: @2936 Sierra Point Place
 City: Salt Lake State UT Zip: 84109
 Telephone: (801) 566-1886
 E-mail address: eafloor@msn.com
 Signature: *George Klinell*

Check here if this is a change of address.

RECEIVED
 BLM AZ STATE OFFICE
 2009 AUG 24 A 8:47
 PUEBLO, ARIZONA
 BLM Date Stamp

LINE NO.	AMC NUMBER	CLAIM/SITE NAME	COUNTY RECORDER DATA (If available)	TWP	RNG	SEC
1	345615	ABS I				
2	345616	ABS II				
3	345617	ABS III				
4	345618	ABS IV				
5	345619	ABS V				
6	345620	ABS VI				
7	345621	ABS VII				
8	345622	ABS VIII				
9	352455	ABSM I-R				
10	352456	ABSM - II-R				

List additional claims on Form MCF114.

Bureau of Land Management
Arizona State Office
www.blm.gov/az/

No. of Claims: 10 x \$140 = \$1,400.00
 Check No: 76101980 Init. AMC
 Receipt No.: 1986467
 For BLM Use Only



Form: MCF112
 Revised July 2009

This form is available from the **Arizona Department of Mines and Mineral Resources** and may be reproduced.

3050623

copy

The Quantum Group of Companies

Quantum Science, L.C. • Quantum Management Services Group, Inc.

2936 Sierra Point Place • Salt Lake City, Utah 84109 USA

Tel: (801) 466-6037 • Fax: (801) 466-3352

Monday, August 17, 2009
Salt Lake City, Utah

Via ~~DEL~~ ~~FED~~ ~~EX~~

Bureau of Land Management – USDI
Arizona State Office
One North Central Avenue – Suite 800
Phoenix, Arizona 85004-4427

PHOENIX, ARIZONA

2009 AUG 24 A 8:48

RECEIVED
BLM AZ STATE OFFICE

Re: Maintenance Fee Payments

Gentlemen:

Enclosed you will find an official check for \$1,400.00 issued to Bureau of Land Management – Arizona to cover annual Mining Claim Maintenance fees for Arizona BLM Claims # AMC 345615-622, Claim names ABS I through ABS VIII, and Arizona BLM Claims # AMC 352455-456, Claim names ABSM-I-R and ABSM-II-R.

Should you have any questions you may contact Emanuel Floor at the above address and telephone number.

Please send the receipt to me at the above address using the prepaid ~~DEL~~ ~~FED~~ ~~EX~~ waybill enclosed.

Sincerely

George Klinell
Lead Agent

MAINTENANCE FEE PAYMENT

Claimant Name: George Klinell
 Address: @2936 Sierra Point Place
 City: Salt Lake State UT Zip: 84109
 Telephone: (801) 566-1886
 E-mail address: eaflor@msn.com
 Signature: *George Klinell*
 Check here if this is a change of address.

RECEIVED
 BLM AZ STATE OFFICE
 2009 AUG 24 A 8:48
 PHOENIX, ARIZONA
 BLM
 Date
 Stamp

LINE NO.	AMC NUMBER	CLAIM/SITE NAME	COUNTY RECORDER DATA (If available)	TWP	RNG	SEC
1	345615	ABS I				
2	345616	ABS II				
3	345617	ABS III				
4	345618	ABS IV				
5	345619	ABS V				
6	345620	ABS VI				
7	345621	ABS VII				
8	345622	ABS VIII				
9	352455	ABSM I-R				
10	352456	ABSM - II-R				

List additional claims on Form MCF114.

No. of Claims: 10 x \$140 = \$1,400.00
 Check No: _____ Init. _____
 Receipt No.: _____
 For BLM Use Only

Bureau of Land Management
 Arizona State Office
www.blm.gov/az/

Form: MCF112
 Revised July 2009

This form is available from the Arizona Department of Mines and Mineral Resources and may be reproduced.

The Quantum Group of Companies

Quantum Science, LC. • Quantum Management Services Group, Inc.

2936 Sierra Point Place • Salt Lake City, Utah 84109 USA

Tel: (801) 466-6037 • Fax: (801) 466-3352

Monday, August 17, 2009
Salt Lake City, Utah

Via ~~DHL~~ **FED EX**

Bureau of Land Management – USDI
Arizona State Office
One North Central Avenue – Suite 800
Phoenix, Arizona 85004-4427

Re: Maintenance Fee Payments

Gentlemen:

Enclosed you will find an official check for \$1,400.00 issued to Bureau of Land Management – Arizona to cover annual Mining Claim Maintenance fees for Arizona BLM Claims # AMC 345615-622, Claim names ABS I through ABS VIII, and Arizona BLM Claims # AMC 352455-456, Claim names ABSM-I-R and ABSM-II-R.

Should you have any questions you may contact Emanuel Floor at the above address and telephone number.

Please send the receipt to me at the above address using the prepaid ~~DHL~~ **FED EX** waybill enclosed.

Sincerely

George Klimel
Lead Agent

PHOENIX, ARIZONA

2009 AUG 24 A 8:47

RECEIVED
BLM AZ STATE OFFICE

United States Department of the Interior

Bureau of Land Management
 BUSINESS & SUPPORT SVCS DIV
 ONE N CENTRAL AVE SUITE 800
 PHOENIX, AZ 85004 -4427
 Phone: (602) 417-9200

Receipt

No: 1986467

Transaction #: 2050623	
Date of Transaction: 08/25/2009	
CUSTOMER:	GEORGE KLINELL 2936 SIERRA POINT PL SALT LAKE CITY, UT 84109-1944 US

LINE #	QTY	DESCRIPTION	REMARKS	UNIT PRICE	TOTAL
1	1.00	LOCATABLE MINERALS / MINING CLAIMS-NOT NEW-UNADJUD, ONE AUTH NO. ONLY / MINING CLAIM MONEY RECEIVED CASES: AMC345615/\$1400.00	MAINT 2010/10	- n/a -	1400.00
TOTAL:					\$1,400.00

PAYMENT INFORMATION			
1	AMOUNT:	1400.00	POSTMARKED: N/A
	TYPE:	CHECK	RECEIVED: 08/25/2009
	CHECK NO:	0076101980	
	NAME:	KLINELL, GEORGE 2936 SIERRA POINT PL SALT LAKE CITY UT 84109-1944 US	

REMARKS

This receipt was generated by the automated BLM Collections and Billing System and is a paper representation of a portion of the official electronic record contained therein.

Lmc 345615

Lmc 352455

MAINTENANCE FEE PAYMENT

Claimant Name: George Klinell
Address: @2936 Sierra Point Place
City: Salt Lake State: UT Zip: 84109
Telephone: (801) 566-1886
E-mail address: gafloor@msn.com
Signature: *George Klinell*

BLM
Date
Stamp

Check here if this is a change of address.

LINE NO.	AMC NUMBER	CLAIM/SITE NAME	COUNTY RECORDER DATA (If available)	TWP	RNG	SEC
1	345615	ABS I				
2	345616	ABS II				
3	345617	ABS III				
4	345618	ABS IV				
5	345619	ABS V				
6	345620	ABS VI				
7	345621	ABS VII				
8	345622	ABS VIII				
9	352455	ABSM I-R				
10	352456	ABSM II-R				

List additional claims on Form MCF114.

Bureau of Land Management
Arizona State Office
www.az.blm.gov

No. of Claims: 10 x \$125 = \$1,250.00
 Check No: 76201627 Init. JMC
 Receipt No.: 1775292
 For BLM Use Only

Form: MCF112
Revised July 2005

This form is available from the **Arizona Department of Mines and Mineral Resources** and may be reproduced.

ENTERED INTO COMPUT

SEP 16 08

[Signature]

United States Department of the Interior
 Bureau of Land Management
 BUSINESS & SUPPORT SVCS DIV
 ONE N CENTRAL AVE SUITE 800
 PHOENIX, AZ 85004 -4427
 Phone: (602) 417-9200

Receipt

No:

1775292

Transaction #: 1833065	
Date of Transaction: 08/29/2008	
CUSTOMER:	GEORGE KLINELL QUANTUM SCIENCE 2936 SIERRA POINT PL SALT LAKE CITY, UT 84109

LINE #	QTY	DESCRIPTION	REMARKS	UNIT PRICE	TOTAL
1	1.00	LOCATABLE MINERALS / MINING CLAIMS-NOT NEW-UNADJUD, ONE AUTH NO. ONLY / MINING CLAIM MONEY RECEIVED (455) CASES: AMC345615/\$1250.00	MAINT 2009/10	- n/a -	1250.00
TOTAL:					\$1,250.00

PAYMENT INFORMATION					
1	AMOUNT:	\$1,250.00	POSTMARKED:	8/25/08 0:00	
	TYPE:	CHECK	RECEIVED:	08/27/2008	
	CHECK NO:	0076201627			
	NAME:	QUANTUM SCIENCE 2936 SIERRA POINT PL SALT LAKE CITY UT 84109			

REMARKS

This receipt was generated by the automated BLM Collections and Billing System and is a paper representation of a portion of the official electronic record contained therein.

345615
352455

The Quantum Group of Companies

Quantum Science, LC. • Quantum Management Services Group, Inc.
2936 Sierra Point Place • Salt Lake City, Utah 84109 USA
Tel: (801) 466-6037 • Fax: (801) 466-3352

Monday, August 27, 2007
Salt Lake City, Utah

Via DHL – 796-8911-963

Bureau of Land Management – USDI
Arizona State Office
One North Central Avenue – Suite 800
Phoenix, Arizona 85004-4427

Re: Maintenance Fee Payments

Gentlemen:

Enclosed you will find an official check for \$1,250.00 issued to Bureau of Land Management – Arizona to cover annual Mining Claim Maintenance fees for Arizona BLM Claims # AMC 345615-622, Claim names ABS I through ABS VIII, and Arizona BLM Claims # AMC 352455-456, Claim names ABSM-I-P and ABSM-II-R.

Should you have any questions you may contact Emanuel Floor at the above address and telephone number.

Please send the receipt to me at the above address using the prepaid DHL waybill enclosed. (#796-8911-985)

Sincerely

George Klinell
Lead Agent

RECEIVED
BLM ARIZONA STATE OFFICE
2007 AUG 29 A 8:29
PHOENIX, ARIZONA

MAINTENANCE FEE PAYMENT

Claimant Name: GEORGE KLINELL
 Address: 2936 S. Sierra Point Place
 City: Salt Lake State: UT Zip: 84109-1944
 Telephone: (801) 466-6037
 E-mail address: eaafloor@msn.com
 Signature: *George Klinell*

Check here if this is a change of address.

RECEIVED
 BLM ARIZONA STATE OFFICE
 PHOENIX, ARIZONA
 2001 AUG 29 A 8:29
 BLM
 Date
 Stamp

LINE NO.	AMC NUMBER	CLAIM/SITE NAME	COUNTY RECORDER DATA (If available)	TWP	RNG	SEC
1	345615	ABS I				
2	345616	ABS II				
3	345617	ABS III				
4	345618	ABS IV				
5	345619	ABS V				
6	345620	ABS VI				
7	345621	ABS VII				
8	345622	ABS VIII				
9	352455	ABSM I-R				
10	352456	ABSM II-R				

List additional claims on Form MCF114.

Bureau of Land Management
Arizona State Office
www.az.blm.gov

No. of Claims: 10 x \$125 = \$1250.00
 Check No: 31221038 Init. SPB
 Receipt No.: 1556265
For BLM Use Only

Form: MCF112
 Revised July 2005

This form is available from the **Arizona Department of Mines and Mineral Resources** and may be reproduced.

United States Department of the Interior
 Bureau of Land Management
 BUSINESS & SUPPORT SVCS DIV
 ONE N CENTRAL AVE SUITE 800
 PHOENIX, AZ 85004 -4427
 Phone: (602) 417-9200

Receipt

No: 1556265

Transaction #: 1607876	ENTERED INTO COMPUTER
Date of Transaction: 08/29/2007	
CUSTOMER: GEORGE KLINELL 2936 S. SIERRA POINT PLACE SALT LAKE CITY, UT 84109	SEP 13 2007 PB <i>to verified</i>

LINE #	QTY	DESCRIPTION	REMARKS	UNIT PRICE	TOTAL
1	1.00	LOCATABLE MINERALS / MINING CLAIMS-NOT NEW-UNADJUD, ONE AUTH NO. ONLY / MINING CLAIM MONEY RECEIVED (455) CASES: AMC345615/\$1250.00	MAINT 2008 (10)	- n/a -	1250.00
TOTAL:					\$1,250.00

PAYMENT INFORMATION					
1	AMOUNT:	\$1,250.00	POSTMARKED:	8/27/07 0:00	
	TYPE:	CHECK	RECEIVED:	08/29/2007	
	CHECK NO:	372210380			
	NAME:	KLINELL, GEORGE 2936 S. SIERRA POINT PLACE SALT LAKE CITY UT 84109			

REMARKS

This receipt was generated by the automated BLM Collections and Billing System and is a paper representation of a portion of the official electronic record contained therein.

AMC 345615
352455

The Quantum Group of Companies

Quantum Science, LC. • Quantum Management Services Group, Inc.

2936 Sierra Point Place • Salt Lake City, Utah 84109 USA

Tel: (801) 466-6037 • Fax: (801) 466-3352

Wednesday, August 23, 2006
Salt Lake City, Utah

Via DHL

Bureau of Land Management – USDI
Arizona State Office
One North Central Avenue – Suite 800
Phoenix, Arizona 85004-4427

PHOENIX, ARIZONA

2006 AUG 29 A 10: 55

RECEIVED
B.L.M. AZ STATE OFFICE

Re: Maintenance Fee Payments

Gentlemen:

Enclosed you will find an official check for \$1,250.00 issued to Bureau of Land Management – Arizona to cover annual Mining Claim Maintenance fees for Arizona BLM Claims # AMC 345615-622, Claim names ABS I through ABS VIII, and Arizona BLM Claims # AMC 352455-456, Claim names ABSM-I-P and ABSM-II-R.

Should you have any questions you may contact Emanuel Floor at the above address and telephone number.

Please send the receipt to me at the above address.

Sincerely

George Klinell
Lead Agent

MAINTENANCE FEE PAYMENT

Claimant Name: GEORGE KLINELL
 Address: 2936 S. Sierra Point Place
 City: Salt Lake State: UT Zip: 84109-1944
 Telephone: (801) 466-6037
 E-mail address: eaflor@msn.com
 Signature: *George Klinell*
 Check here if this is a change of address.

RECEIVED
 B.L.M. AZ STATE OFFICE
 2006 AUG 29 A 10:55
 PHOENIX, ARIZONA
 BLM
 Date
 Stamp

LINE NO.	AMC NUMBER	CLAIM/SITE NAME	COUNTY RECORDER DATA (If available)	TWP	RNG	SEC
1	345615	ABS I				
2	345616	ABS II				
3	345617	ABS III				
4	345618	ABS IV				
5	345619	ABS V				
6	345620	ABS VI				
7	345621	ABS VII				
8	345622	ABS VIII				
9	352455	ABSM I-R				
10	352456	ABSM II - R				

List additional claims on Form MCF114.

Bureau of Land Management
Arizona State Office
www.az.blm.gov

No. of Claims: 10 x \$125 = 1250.00
 Check No: 389048818 Init. TES
 Receipt No.: 1348209
For BLM Use Only

Form: MCF112
 Revised July 2005

United States Department of the Interior
 Bureau of Land Management
 BUSINESS & SUPPORT SVCS DIV
 ONE N CENTRAL AVE
 PHOENIX, AZ 85004 -2203
 Phone: (602) 417-9200

Receipt

No: 1348209

Transaction #: 1393485		ENTERED INTO COMPUTER
Date of Transaction: 08/30/2006		
CUSTOMER:	THE QUANTUM GROUP CO 2936 SIERRA POINT PLACE SALT LAKE CITY, UT 84109	SEP 01 2006 <i>PS</i>

LINE #	QTY	DESCRIPTION	REMARKS	UNIT PRICE	TOTAL
1	1.00	LOCATABLE MINERALS / MINING CLAIMS-NOT NEW-UNADJUD, ONE AUTH NO. ONLY / MINING CLAIM MONEY RECEIVED (455) CASES: AMC345615/\$1250.00	MAINT 2007 (10)	- n/a -	1250.00
TOTAL:					\$1,250.00

PAYMENT INFORMATION					
1	AMOUNT:	\$1,250.00	POSTMARKED:	N/A	
	TYPE:	CHECK	RECEIVED:	08/29/2006	
	CHECK NO:	389048818			
	NAME:	KEYBANK NATIONAL ASSOCIATION 2299 HIGHLAND DR SALT LAKE CITY UT 84106			

REMARKS

This receipt was generated by the automated BLM Collections and Billing System and is a paper representation of a portion of the official electronic record contained therein.

United States Department of the Interior
Bureau of Land Management
 BUSINESS & SUPPORT SVCS DIV
 222 N CENTRAL AVE
 PHOENIX, AZ 85004 -2203
 Phone: (602) 417-9200

Receipt

No: 1138604

Transaction #: 1177771		AMC 345615
Date of Transaction: 08/26/2005		AMC 352455
CUSTOMER:	QUANTUM SCIENCES, LC 2963 SIERRA POINT PLACE SALT LAKE CITY, UT 84109	

LINE #	QTY	DESCRIPTION	REMARKS	UNIT PRICE	TOTAL
1	1.00	LOCATABLE MINERALS / MINING CLAIMS- NOT NEW-UNADJUD, ONE AUTH NO. ONLY / MINING CLAIM MONEY RECEIVED (455) CASES: AMC345615/\$1250.00	MAINT 2006 (10)	- n/a -	1250.00
TOTAL:					\$1,250.00

PAYMENT INFORMATION			
1	AMOUNT:	\$1,250.00	POSTMARKED: 08/23/2005
	TYPE:	CHECK	RECEIVED: 08/24/2005
	CHECK NO:	174272231	
	NAME:	QUANTUM 2963 SIERRA POINT PLACE SALT LAKE CITY UT 84109	

REMARKS

This receipt was generated by the automated BLM Collections and Billing System and is a paper representation of a portion of the official electronic record contained therein.

ENTERED BY [unclear]
 RE 9/8/05

The Quantum Group of Companies

Quantum Sciences, LC.

2936 Sierra Point Place, Salt Lake City, Utah 84109 • USA

Tel: (801) 466-6037 • Fax: (801) 466-6532

E-Mail eafloor@msn.com

Tuesday, August 23, 2003
Salt Lake City, Utah

Via Overnight Mail
DHL – 796 8911 856

Bureau of Land Management – USDI
Arizona State Office
222 North Central Avenue
Phoenix, Arizona 85004

Suite 101 – Mining Claims

Re : Maintenance Fee Payments

Gentlemen:

Enclosed you will find an official check for \$1,250.00 issued to Bureau of Land Management – Arizona to cover the annual Mining Claim Maintenance fees for Arizona BLM Claims # AMC 345615-622, Claim names: ABS I through ABS VIII, and Arizona BLM Claims # AMC 352455-456, claim names: ABSM-I-R and AMSM-II-R.

Should you have any questions you may contact Emanuel Floor at the above address and phone number.

Sincerely

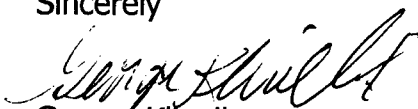

George Klinell
Lead Agent

Please send the receipt to me at 2936 South Sierra Point Place, Salt Lake City, Utah 84109.

ARIZONA
STATE OFFICE
PHOENIX, ARIZONA

2005 AUG 24 P 12: 50

RECEIVED
BUREAU OF
LAND MANAGEMENT

MAINTENANCE FEE PAYMENT

Claimant Name: GEORGE KLINELL
 Address: 2936 S. Sierra Point Place
 City: Salt Lake State: UT Zip: 84109-1944
 Telephone: (801) 466-6037
 E-mail address: eaflor@msn.com
 Signature: *George Klinell*

Check here if this is a change of address.

RECEIVED
 BUREAU OF
 LAND MANAGEMENT
 2005 AUG 24 P 12: 50
 ARIZONA
 STATE OFFICE
 PHOENIX, ARIZONA
 BLM
 Date
 Stamp

LINE NO.	AMC NUMBER	CLAIM/SITE NAME	COUNTY RECORDER DATA (If available)	TWP	RNG	SEC
1	345615	ABS I				
2	345616	ABS II				
3	345617	ABS III				
4	345618	ABS IV				
5	345619	ABS V				
6	345620	ABS VI				
7	345621	ABS VII				
8	345622	ABS VIII				
9	352455	ABSM I-R				
10	352456	ABSM II - R				

List additional claims on Form MCF114.

No. of Claims: _____ x \$125 = _____
 Check No: _____ Init. _____
 Receipt No.: _____
For BLM Use Only

Bureau of Land Management
Arizona State Office
www.az.blm.gov

Form: MCF112
 Revised July 2005

This form is available from the **Arizona Department of Mines and Mineral Resources** and may be reproduced.

RE 9/8/05

The Quantum Group of Companies

Quantum Science, LC • Quantum Management Services Group, Inc.
2936 S. Sierra Point Place • Salt Lake City, Utah 84109-1944 USA
Tel: (801) 466-6037 • Fax: (801) 466-6532

AMC 345615
352455

Wednesday, August 25, 2004

Via DHL Delivery

Bureau of Land Management – USDI
Arizona State Office
222 North Central Avenue
Phoenix, Arizona 85004

RECEIVED
BUREAU OF
LAND MANAGEMENT
2004 AUG 26 A 11:15
ARIZONA
STATE OFFICE
PHOENIX, ARIZONA

Re: Maintenance Fee Payments

Gentlemen:

Enclosed you will find an official check for \$1,250.00 issued to Bureau of Land Management – Arizona to cover the annual Mining Claim Maintenance fees for Arizona BLM Claims # AMC 345615-622, Claim names ABS I through ABS VIII, and Arizona BLM Claims # AMC 352455-456, Claim names ABSM-I-R and ABSM-II-R.

Should you have any questions, you may contact Emanuel Floor at the above address and phone number.

Sincerely

George Kinnell
Lead Agent.

Please send the receipt to me at the above address.

10/104TK
ENTERED INTO COMPUTER

MAINTENANCE FEE PAYMENT

\$125

Mining Claim Maintenance Fee Payment of \$100 per claim or site is due on or before September 1, 2004, in lieu of assessment work for the upcoming assessment year beginning September 1 of the year noted above.

BUREAU OF LAND MANAGEMENT
ARIZONA STATE OFFICE
222 NORTH CENTRAL AVENUE
PHOENIX, AZ 85004
602-417-9200
www.az.blm.gov

FOR BLM USE ONLY	
NO. OF CLAIMS: <u>10</u>	X \$100 = \$ _____
RECEIPT NO: _____	CHECK NO: _____
INIT: _____	

BLM SERIAL NUMBERS	NAME OF CLAIMS/SITES	COUNTY	BOOK/DOCKET & PAGE OR FEE NUMBER
1. AMC 345615	ABS I		
2. AMC 345616	ABS II		
3. AMC 345617	ABS III		
4. AMC 345618	ABS IV		
5. AMC 345619	ABS V		
6. AMC 345620	ABS VI		
7. AMC 345621	ABS VII		
8. AMC 345622	ABS VIII		
9. AMC 352455	ABSM I-R		
10. AMC 352456	ABSM II -R		

List additional claims on the reverse side of this form.

CHECK HERE IF THIS IS A CHANGE OF ADDRESS

CLAIMANT'S NAME: George Klinell

ADDRESS: 2936 S. Sierra Point Place
CITY: Salt Lake City STATE: Utah ZIP: 84109-1944
PHONE: (801) 466-6037

Signature: *George Klinell*

To record with the County, one claimant or an agent must sign.

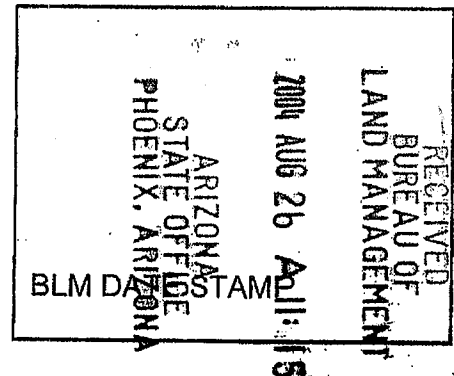

MAINTENANCE FEE PAYMENT

\$125

Mining Claim Maintenance Fee Payment of \$100 per claim or site is due on or before September 1, 2004, in lieu of assessment work for the upcoming assessment year beginning September 1 of the year noted above.

BUREAU OF LAND MANAGEMENT
ARIZONA STATE OFFICE
222 NORTH CENTRAL AVENUE
PHOENIX, AZ 85004
602-417-9200
www.az.blm.gov

FOR BLM USE ONLY	
NO. OF CLAIMS: <u>10</u>	X \$100 = \$ <u> </u>
RECEIPT NO: <u> </u>	CHECK NO: <u> </u>
INIT: <u> </u>	

BLM SERIAL NUMBERS	NAME OF CLAIMS/SITES	COUNTY BOOK/DOCKET & PAGE OR FEE NUMBER
1. AMC 345615	ABS I	
2. AMC 345616	ABS II	
3. AMC 345617	ABS III	
4. AMC 345618	ABS IV	
5. AMC 345619	ABS V	
6. AMC 345620	ABS VI	
7. AMC 345621	ABS VII	
8. AMC 345622	ABS VIII	
9. AMC 352455	ABSM I-R	
10. AMC 352456	ABSM II -R	

List additional claims on the reverse side of this form.

CHECK HERE IF THIS IS A CHANGE OF ADDRESS

CLAIMANT'S NAME: George Klinell

ADDRESS: 2936 S. Sierra Point Place

CITY: Salt Lake City STATE: Utah ZIP: 84109-1944

PHONE: (801) 466-6037

Signature: *George Klinell*

To record with the County, one claimant or an agent must sign.

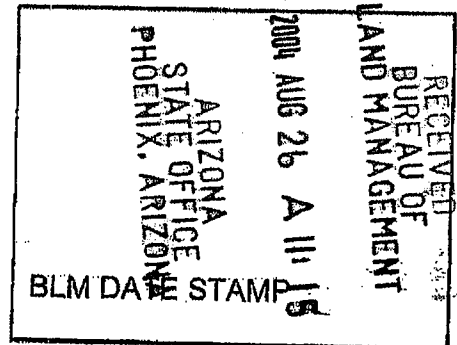

MAINTENANCE FEE PAYMENT

\$125

Mining Claim Maintenance Fee Payment of \$100 per claim or site is due on or before September 1, 2004, in lieu of assessment work for the upcoming assessment year beginning September 1 of the year noted above.

BUREAU OF LAND MANAGEMENT
ARIZONA STATE OFFICE
222 NORTH CENTRAL AVENUE
PHOENIX, AZ 85004
602-417-9200
www.az.blm.gov

FOR BLM USE ONLY	
NO. OF CLAIMS: <u>10</u>	X \$400 = \$ <u>1,250.00</u>
RECEIPT NO: <u>939857</u>	CHECK NO: <u>889016673</u>
INIT: <u>SC</u>	

BLM SERIAL NUMBERS	NAME OF CLAIMS/SITES	COUNTY BOOK/DOCKET & PAGE OR FEE NUMBER
1. AMC 345615	ABS I	
2. AMC 345616	ABS II	
3. AMC 345617	ABS III	
4. AMC 345618	ABS IV	
5. AMC 345619	ABS V	
6. AMC 345620	ABS VI	
7. AMC 345621	ABS VII	
8. AMC 345622	ABS VIII	
9. AMC 352455	ABSM I-R	
10. AMC 352456	ABSM II -R	

List additional claims on the reverse side of this form.

CHECK HERE IF THIS IS A CHANGE OF ADDRESS

CLAIMANT'S NAME: George Klinell

ADDRESS: 2936 S. Sierra Point Place

CITY: Salt Lake City STATE: Utah ZIP: 84109-1944

PHONE: (801) 466-6037

Signature: _____

To record with the County, one claimant or an agent must sign.

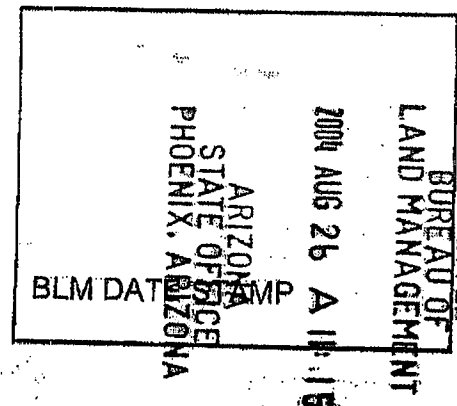

United States Department of the Interior
Bureau of Land Management
 BUSINESS & SUPPORT SVCS DIV
 222 N CENTRAL AVE
 PHOENIX, AZ 85004 -2203
 Phone: (602) 417-9200

Receipt	
No:	939857

Transaction #: 974199
Date of Transaction: 08/27/2004

CUSTOMER:	GEORGE KLINELL 2936 S SIERRA POINT PLACE SALT LAKE CITY, UT 84109
------------------	---

LINE #	QTY	DESCRIPTION	REMARKS	UNIT PRICE	TOTAL
1	1.00	LOCATABLE MINERALS / MINING CLAIMS-NOT NEW-UNADJUD, ONE AUTH NO. ONLY / MINING CLAIM MONEY RECEIVED (455) CASES: AMC345615/\$1250.00	MAINT 2005 (10)	- n/a -	1250.00
TOTAL:					\$1,250.00

PAYMENT INFORMATION																	
1	<table border="0"> <tr> <td>AMOUNT:</td> <td>\$1,250.00</td> <td>POSTMARKED:</td> <td>08/26/2004</td> </tr> <tr> <td>TYPE:</td> <td>CHECK</td> <td>RECEIVED:</td> <td>08/26/2004</td> </tr> <tr> <td>CHECK NO:</td> <td>889016673</td> <td></td> <td></td> </tr> <tr> <td>NAME:</td> <td colspan="3">QUANTUM SCIENCE, LC 2936 S SIERRA POINT PLACE SALT LAKE CITY UT 84109</td> </tr> </table>	AMOUNT:	\$1,250.00	POSTMARKED:	08/26/2004	TYPE:	CHECK	RECEIVED:	08/26/2004	CHECK NO:	889016673			NAME:	QUANTUM SCIENCE, LC 2936 S SIERRA POINT PLACE SALT LAKE CITY UT 84109		
AMOUNT:	\$1,250.00	POSTMARKED:	08/26/2004														
TYPE:	CHECK	RECEIVED:	08/26/2004														
CHECK NO:	889016673																
NAME:	QUANTUM SCIENCE, LC 2936 S SIERRA POINT PLACE SALT LAKE CITY UT 84109																

REMARKS

This receipt was generated by the automated BLM Collections and Billing System and is a paper representation of a portion of the official electronic record contained therein.

Tuesday, August 26, 2003
Salt Lake City, Utah

AMC 352455
AMC 345415

Via Hand Delivery

Bureau of Land Management – USDI
Arizona State Office
222 North Central Avenue
Phoenix, Arizona 85004

LAND MANAGEMENT I
2003 AUG 29 A 10:45
ARIZONA
STATE OFFICE
PHOENIX, ARIZONA

Re : Maintenance Fee Payments

Gentlemen:

Enclosed you will find an official check for \$1,000.00 issued to Bureau of Land Management – Arizona to cover the annual Mining Claim Maintenance fees for Arizona BLM Claims # AMC 345615-622, Claim names: ABS I through ABS VIII, and Arizona BLM Claims # AMC 352455-456, claim names: ABSM-I-R and AMSM-II-R.

Should you have any questions you may contact Emanuel Floor at the above address and phone number.

Sincerely

George Klinell
George Klinell
Lead Agent

Please send the receipt to me at 2936 South Sierra Point Place, Salt Lake City, Utah 84109. This is a new address for the claim.

9/9/03 RES
ENTERED INTO COMPUTER

[Handwritten mark]

MAINTENANCE FEE PAYMENT

Mining Claim Maintenance Fee Payment of \$100 per claim or site is due on or before September 1, 2003, in lieu of assessment work for the upcoming assessment year beginning September 1 of the year noted above.

BUREAU OF LAND MANAGEMENT
 ARIZONA STATE OFFICE
 222 NORTH CENTRAL AVENUE
 PHOENIX, AZ 85004
 602-417-9200
 www.az.blm.gov

FOR BLM USE ONLY	
NO. OF CLAIMS: <u>10</u>	X \$100 = \$ <u>1,000.00</u>
RECEIPT NO: <u>743 825</u>	CHECK NO: <u>61-592482236</u>
INIT: <u>PMC</u>	

BLM SERIAL NUMBERS	NAME OF CLAIMS/SITES	COUNTY BOOK/DOCKET & PAGE OR FEE NUMBER
1. AMC 345615	ABS I	
2. AMC 345616	ABS II	
3. AMC 345617	ABS III	
4. AMC 345618	ABS IV	
5. AMC 345619	ABS V	
6. AMC 345620	ABS VI	
7. AMC 345621	ABS VII	
8. AMC 345622	ABS VIII	
9. AMC 352455	ABSM I-R	
10. AMC 352456	ABSM II-R	

List additional claims on the reverse side of this form.

CHECK HERE IF THIS IS A CHANGE OF ADDRESS

CLAIMANT'S NAME: George Klinell

ADDRESS: 2936 S. Sierra Point Place
 CITY: Salt Lake City STATE: Utah ZIP: 84109-1944
 PHONE: (801) 466-6037

Signature: *George Klinell*

To record with the County, one claimant or an agent must sign.

RECEIVED BUREAU OF LAND MANAGEMENT	
2003 AUG 29 A 4:45	
ARIZONA STATE OFFICE PHOENIX, ARIZONA	
BLM DATE STAMP	

United States Department of the Interior
Bureau of Land Management
 BUSINESS & SUPPORT SVCS DIV
 222 N CENTRAL AVE
 PHOENIX, AZ 85004 -2203
 Phone: (602) 417-9200

Receipt	
No:	743825

Transaction #: 773418
Date of Transaction: 09/02/2003
CUSTOMER: GEORGE KLINELL 2936 S SIERRA POINT PLACE SALT LAKE CITY, UT 84109-1944

LINE #	QTY	DESCRIPTION	REMARKS	UNIT PRICE	TOTAL
1	1.00	LOCATABLE MINERALS / MINING CLAIMS-NOT NEW-UNADJUD, ONE AUTH NO. ONLY / MINING CLAIM MONEY RECEIVED (455) CASES: AMC345615/\$1000.00	MAINT 2004 (10)	- n/a -	1000.00
TOTAL:					\$1,000.00

PAYMENT INFORMATION					
1	AMOUNT:	\$1,000.00	POSTMARKED:	08/26/2003	
	TYPE:	CHECK	RECEIVED:	08/29/2003	
	CHECK NO:	61-592482236			
	NAME:	KLINELL, GEORGE 2936 S SIERRA POINT PLACE SALT LAKE CITY UT 84109 1944			

REMARKS

This receipt was generated by the automated BLM Collections and Billing System and is a paper representation of a portion of the official electronic record contained therein.

Receipt No. 552620

LEAD FILE #'S _____

Trans No. 577362

AMC 345615 ; AMC 352455

AMC Number	Code	Amount
345615 - 345622	482	800
352455 - 352456	482	200
TOTAL:		\$1000⁰⁰

AMC Number	Code	Amount
TOTAL:		\$

Date of Doc 8/29/2002

Date Entered: RE 9/11/2002

Date of Rec't 8/30/2002

Date Verified: 9/18/02 AB

Amount Rec'd \$1000.00

Sent to Accts: " "

Amount Earned \$1000.00

Date Earned: _____

- 480 POL
- 481 NOI
- 482 MAINT
- 396 TRANS
- 635 AMEND

NOTES:

**United States Department of the Interior
Bureau of Land Management
BUSINESS & SUPPORT SVCS DIV
222 N CENTRAL AVE
PHOENIX, AZ 85004 -2203
Phone: (602) 417-9200**

Receipt	
No.	552620

Transaction #: 577362	
Date of Transaction: 08/30/2002	
CUSTOMER:	QUANTUM SCIENCES, LC 7050 S UNION PARK CENTER SUITE 410 SALT LAKE CITY, UT 84047

LINE #	QTY	DESCRIPTION	REMARKS	UNIT PRICE	TOTAL
1	1.00	LOCATABLE MINERALS / MINING CLAIMS-NOT NEW-UNADJUD, ONE AUTH NO. ONLY / MINING CLAIM MONEY RECEIVED (455) CASES: AMC345615/\$1000.00	MAINT 2003 (10)	- n/a -	1000.00
TOTAL:					\$1,000.00

PAYMENT INFORMATION			
1	AMOUNT	\$1,000.00	POSTMARKED 08/28/2002
	TYPE	CHECK	RECEIVED 08/29/2002
	CHECK NO.	1262	
	NAME	QUANTUM SCIENCES, LC 7050 S UNION PARK CENTER SUITE 410 SALT LAKE CITY UT 84047	

REMARKS

This receipt was generated by the automated BLM Collections and Billing System and is a paper representation of a portion of the official electronic record contained therein.

The Quantum Group of Companies

Quantum Sciences, LC. • Quantum Management Services Group, Inc.

7050 Union Park Center – Suite 410 • Salt Lake City, Utah 84047 USA

Tel: (801) 208-3040 • Fax: (801) 208-3033

August 28, 2002



U.S. Dept. of the Interior
Bureau of Land Management
Arizona State Office
222 North Central Avenue
Phoenix, AZ 85004-2203

To Whom It May Concern:

Enclosed you will find a check for \$1,000.00 to cover the annual Mining Claim Maintenance fees for Arizona BLM claims # AMC 345615-622, claim names: ABS-I thru VIII, and Arizona BLM claims # AMC 352455-456, claim names: ABSM-I-R and ABSM-II-R.

18 claims

Should you have any questions, please contact me at your earliest convenience.

Sincerely,

George Klinell
George Klinell
Lead Agent

ENTERED IN COMPUTER
RE 9/11/2002

Receipt No. 360393

Trans No. 378926

LEAD FILE #'S 352455

345619

AMC Number	Code	Amount
345619-345622	482	800.00
352455-352456	482	200.00
TOTAL:	482	\$1000.00

AMC Number	Code	Amount
TOTAL:		\$

Date of Doc 8/20/01

Date of Rec't 8/20/01

Amount Rec'd 1000.00

Amount Earned \$1,000.00

Date Entered: 10/23/01 TK

Date Verified:

Sent to Accts:

Date Earned:

- 480 POL
- 481 NOI
- 482 MAINT
- 396 TRANS
- 635 AMEND

NOTES:

The Quantum Group of Companies

Quantum Sciences, LC. • Quantum Management Services Group, Inc.

7050 Union Park Center – Suite 410 • Salt Lake City, Utah 84047 USA

Tel: (801) 208-3040 • Fax: (801) 208-3033

August 15, 2001

U.S. Dept. of the Interior
Bureau of Land Management
Arizona State Office
222 North Central Avenue
Phoenix, AZ 85004-2203

To Whom It May Concern:

Enclosed you will find a check for \$1,000.00 to cover the annual Mining Claim Maintenance fees for Arizona BLM claims # AMC 345615-622, claim names: ABS-I thru VIII, and Arizona BLM claims # AMC 352455-456, claim names: ABSM-I-R and ABSM-II-R.

Should you have any questions, please contact me at your earliest convenience.

Sincerely,

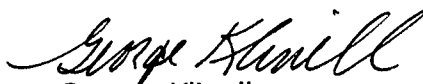

George Klinell
Lead Agent

RECEIVED
BUREAU OF
LAND MANAGEMENT
2001 AUG 20 A 10:52
ARIZONA
STATE OFFICE
PHOENIX, ARIZONA

TJC 10/23/01
ENTERED INTO COMPUTER

**United States Department of the Interior
Bureau of Land Management**
BUSINESS & SUPPORT SVCS DIV
222 N CENTRAL AVE
PHOENIX, AZ 85004 -2203
Phone: (602) 417-9200

Receipt	
No:	360393

Transaction #: 378926
Date of Transaction: 08/20/2001

CUSTOMER: GEORGE KLINELL
7050 S UNION PARK CENTER
STE 410
SALT LAKE CITY, UT 84047

LINE #	QTY	COMMODITY / SUBJECT / ACTION / PRODUCT	REMARKS	UNIT PRICE	TOTAL
1	1.00	LOCATABLE MINERALS / MINING CLAIMS-NOT NEW-UNADJUD, ONE AUTH NO. ONLY / MINING CLAIM MONEY RECEIVED (455)	MAINT 2002 (10)	- n/a -	\$1,000.00
TOTAL:					\$1,000.00

PAYMENT INFORMATION			
1	AMOUNT:	\$1,000.00	POSTMARKED: 08/15/2001
	TYPE:	CHECK	RECEIVED: 08/20/2001
	CHECK NO:	1041	
	NAME:	QUANTUM SCIENCES, LC 7050 S UNION PARK CENTER STE 410 SALT LAKE CITY UT 84047	

REMARKS

PHONE: SEE DOC

CASE SERIAL NUMBER INFORMATION		
TRNS #	LINE #	CASES
378926	1	AMC345615/\$1000.00

This receipt was generated by the automated BLM Collections and Billings System and is a paper representation of a portion of the official electronic record contained therein.

Receipt #: 179872

Lead #: 345615, 352455

Amount Received: 1000⁰⁰

Date: 8/30/00

Transaction #: 193176

AMC #	Code	\$\$\$\$
345615 - 345622	482	800
352455 - 352456		200

AMC #	Code	\$\$\$\$

Total: 1000

- 480---POL-----\$5
- 481---NOI-----\$5
- 482---Maint.---\$100
- 396---Trf.-----\$5
- 635---Amd.-----\$5
- 379---Refund

Entered: *AS* SEP 13 2000
Date

Verified: *Ja* 9-15-00
Date

Sent to Accounts: 9-15-00
Date

Earned by Accounts: _____
Date

Quantum Minerals, LLC

7109 South Highland Drive, Suite 100
Salt Lake City, Utah 84121

(801) 944-1313

28 August 2000

U.S. Dept. of the Interior
Bureau of Land Management
Arizona State Office
222 North Central Avenue
Phoenix, Az. 85004-2203

To Whom It May Concern

Enclosed you will find a check for \$1,000.00 to cover the annual Mining Claim Maintenance fees for Arizona BLM claims # ABS-I-VIII and ABSM-I-R and ABSM-II-R.

Should you have any questions please contact me at your earliest convenience.

Sincerely,

George Klinell,
Lead Agent

GK:lp

ARIZONA
STATE OFFICE
PHOENIX, ARIZONA

AUG 30 10 51 AM '00

RECEIVED
BUREAU OF
LAND MANAGEMENT

If the claims/sites have consecutive BLM #'s and are in the same Township, Range and Section(s) they may be listed as follows:

SAMPLE 1-10 A MC 19640-49 Dkt/Pg # 1025/1-10 (or) 4N 20W 36
 RECORDING # 9106173-82

CLAIMS/SITE NAME	SERIAL NUMBER	Dkt/Pg or Recording # of ORIGINAL LOCATION NOTICE	TWN SHP	RNG	SEC(S)
1. ABS-I	A MC 345615	Book 3441 Page 561	10N	2W	8 & 9
2. ABS-II	A MC 345616	564	10N	2W±	9 9
3. ABS-III	A MC 345617	567	10N	2W	9 9
4. ABS-IV	A MC 345618	570	10N	2W	0 99
5. ABS-V	A MC 345619	573	10N	2W	8 & 9
6. ABS-VI	A MC 345620	576	10N	2W	5 & 8
7. ABS-VII	A MC 345621	579	10N	2W	4
8. ABS-VIII	A MC 345622	582	10N	2W	4 & 5
9. ABSM-I-R	A MC 352455	BOOK 3709 PAGE 511	10N	2W	13 7 14
10. ABSM-II-R	A MC 352456	BOOK 3709 PAGE 512	10N	2W	13
11.	A MC				
12.	A MC				
13.	A MC				
14.	A MC				
15.	A MC				
16.	A MC				
17.	A MC				
18.	A MC				
19.	A MC				
20.	A MC				
21.	A MC				
22.	A MC				
23.	A MC				
24.	A MC				
25.	A MC				
26.	A MC				
27.	A MC				
28.	A MC				
29.	A MC				
30.	A MC				

FILE WITH: BUREAU OF LAND MANAGEMENT, 222 NORTH CENTRAL AVENUE, PHOENIX, AZ 85004-2203 and the respective county recorder, ON OR BEFORE DECEMBER 30th (NOT THE 31st). BLM REQUIRES A \$5.00 NONREFUNDABLE SERVICE CHARGE FOR EACH MINING CLAIM, MILL SITE OR TUNNEL SITE, ANNUAL FILLINGS THAT ARE NOT ACCOMPANIED BY PROPER SERVICE CHARGES WILL BE RETURNED WITHOUT FURTHER ACTION BY BLM.

ENTERED INTO COMPUTER

SEP 13 2000

VERIFIED
 Jo 9-15-00

10 sep

United States Department of the Interior
Bureau of Land Management
 BUSINESS & SUPPORT SVCS DIV
 222 N CENTRAL AVE
 PHOENIX, AZ 85004 -2203
 Phone: (602) 417-9200

Receipt	
No:	179872

Transaction #: 193176
Date of Transaction: 08/30/2000

CUSTOMER: GEORGE KLINELL
 8474 S TREASURE MTN
 SANDY, UT 84093

LINE #	QTY	COMMODITY / SUBJECT / ACTION / PRODUCT	REMARKS	UNIT PRICE	TOTAL
1	1	LOCATABLE MINERALS / MINING CLAIMS-ACCOUNTS/UNADJUDICATED / MINING CLAIM MONEY RECEIVED (455)	MAINT 2001 (10)	- n/a -	\$1,000.00
TOTAL:					\$1,000.00

PAYMENT INFORMATION

1	AMOUNT:	\$1,000.00	POSTMARKED:	08/29/2000
	TYPE:	CHECK	RECEIVED:	08/30/2000
	CHECK NO:	1042		
	NAME:	KLINELL, GEORGE A 8474 S TREASURE MTN SANDY UT 84093		

REMARKS

PHONE #801-944-1313

CASE SERIAL NUMBER INFORMATION

TRNS #	LINE #	CASES
193176	1	AMC345615

This receipt was generated by the automated BLM Collections and Billings System and is a paper representation of a portion of the official electronic record contained therein.

NOTICE!!

These documents have been scanned!

Do not place un-scanned documents beneath this notice!

Do not remove this notice from this file!

GPO Jacket No. 560-102
Print Order 61540
Rise Business Services, LLC
Job=AZ15 7/3/2019



Box Number= AZ15140



Claim Begin-End: AMC352455-AMC352456

5 Miscellaneous



AZ15140-14

AMC351599-AMC352455

**NO
DOCUMENTS
FOUND**

NO DOCUMENTS FOUND
NO DOCUMENTS FOUND

NOTICE!!

These documents have been scanned!

Do not place un-scanned documents beneath this notice!

Do not remove this notice from this file!

GPO Jacket No. 560-102
Print Order 61540
Rise Business Services, LLC
Job=AZ15 7/3/2019



Box Number= AZ15140



Claim Begin-End: AMC352455-AMC352456

6 Location Notices-Amendments and Supporting Documents



AZ15140-14

AMC351599-AMC352455

United States Department of the Interior
BUREAU OF LAND MANAGEMENT
ARIZONA STATE OFFICE
222 North Central Avenue
Phoenix, Arizona 85004-2203

November 30, 1999

In Reply Refer To:
3800 (952.3)

CLAIMANT(S):	Hal J. Brostrom 1815 N. Kensington Farmington, UT 84025	Deanna W. Klinell 8474 S. Treasure Mtn. Rd Sandy, UT 84093
	Clark Brown 2184 W. Gentile Layton, UT 84041	Drew J. Klinell 2051 E. Dimple Dell Rd. Sandy, UT 84092
	Don Jares 6321 Mori St. McLean, VA 22101	George Klinell 8474 S. Treasure Mtn. Rd Sandy, UT 84093
	Don Kline 13122 Ranchwood Rd. Tustin, CA 92782	John Pease 4432 West 5820 South Kearns, UT 84118

The enclosed claim index is provided to identify the owner's name, address, and AMC number assigned to the claim(s). If the name and/or address is incorrect, please advise.

If you have any questions, please call Mining Claims Adjudication at (602) 417-9350.

Enclosure

1 From

Date

9-1-99

Sender's Name

GEORGE KINSELL

Phone

(801) 944-1313

Dept./Floor/Suite/Room

Company

QUANTUM MINERALS LLC

Address

8474 S. TREASURE MTN. DR.

City

SANDY

State

UTAH

Zip

84093

2 Your Internal Billing Reference Information**3 To**

Recipient's Name

PUBLIC ROOM

Phone

(602) 417-9382

Dept./Floor/Suite/Room

Company

US BUREAU OF LAND MANAGEMENT

Address

222 N. CENTRAL AVE.

(To 'HOLD' at FedEx location, print FedEx address here)

City

PHOENIX

State

AZ

Zip

85004-2203

For HOLD at FedEx Location check here **Hold Weekday**
(Not available with
FedEx First Overnight) **Hold Saturday** (Not available at all locations)
(Not available with FedEx First Overnight or
FedEx Standard Overnight)**For Saturday Delivery check here** (Extra Charge. Not available to all locations)
(Not available with FedEx First Overnight
or FedEx Standard Overnight)**4a Express Package Service Packages under 150 lbs.**

Delivery commitment may be later in some areas.

 FedEx Priority Overnight
(Next business morning) FedEx Standard Overnight
(Next business afternoon) FedEx 2Day*
(Second business day) **NEW FedEx First Overnight**
(Earliest next business morning delivery to select locations)
(Higher rates apply)* FedEx Letter Rate not available.
Minimum charge:
One pound FedEx 2Day rate.**4b Express Freight Service Packages over 150 lbs.**

Delivery commitment may be later in some areas.

 FedEx Overnight Freight
(Next business-day service
for any distance) FedEx 2Day Freight
(Second business-day
service for any distance) FedEx Express Saver Freight
(Up to 3 business-day service
based upon distance)

(Call for delivery schedule. See back for detailed descriptions of freight products.)

5 Packaging FedEx Letter
Declared value limit \$500 FedEx Pak FedEx Box FedEx Tube Other Pkg.**6 Special Handling**

Does this shipment contain dangerous goods?

 Yes(As per attached
Shipper's
Declaration) Yes(Shipper's
Declaration
not required) Dry Ice

(Dry Ice, 9, UN 1845 III) _____ x _____ kg, 904

(Dangerous Goods Shipper's Declaration not required)

CA

 Cargo Aircraft Only**7 Payment** Obtain Recipient
FedEx Account No.

Bill to:

 Sender
(Account no. in
section 1 will be billed) Recipient Third Party Credit Card Cash/
Check

(Enter FedEx account no. or Credit Card no. below)

Total Packages

Total Weight

Total Declared Value*

Total Charges

/

/

\$

.00

\$

* When declaring a value higher than \$100 per shipment, you pay an additional charge. See SERVICE CONDITIONS, DECLARED VALUE AND LIMIT OF LIABILITY section for further information.

Credit Card Auth.

8 Release Signature

Your signature authorizes Federal Express to deliver this shipment without obtaining a signature and agrees to indemnify and hold harmless Federal Express from any resulting claims.

**Questions?
Call 1-800-Go-FedEx
(1-800-463-3339)**

272

4972040231



10501057PH

Terms And Conditions

Definitions On this airbill, we, our and us refer to Federal Express Corporation, its employees, and agents. You and your refer to the sender, its employees, and agents.

Agreement To Terms By giving us your package to deliver, you agree to all the terms in our current Service Guide, which is available on request. You also agree to those terms on behalf of any third party with an interest in the package. If there is a conflict between the Service Guide and this Airbill, the Service Guide will control. No one is authorized to change the terms of our Agreement.

Responsibility For Packaging And Completing Airbill You are responsible for adequately packaging your goods and properly filling out this airbill. If you omit the number of packages and/or weight per package, our billing will be based on our best estimate of the number of packages we received and/or an estimated "default" weight per package as determined by us.

Responsibility For Payment Even if you give us different payment instructions, you will always be primarily responsible for all delivery costs, as well as any cost we incur in either returning your package to you or warehousing it pending disposition.

Limitations On Our Liability And Liabilities Not Assumed

• Our liability for loss or damage to your package is limited to your actual damage or \$100, unless you declare a higher value, pay an additional charge, and document your actual loss in a timely manner. You may pay an additional charge for each additional \$100 of declared value. The declared value does not constitute, nor do we provide cargo liability insurance.

In any event, we will not be liable for any damage, whether direct, incidental, special, or consequential in excess of the declared value of a shipment, whether or not Federal Express had knowledge that such damages might be incurred including but not limited to loss of income or profits.

• We won't be liable:

- for your acts or omissions including but not limited to improper or insufficient packing, securing, marking, or addressing or those of the recipient or anyone else with an interest in the package

- if you or the recipient violate any of the terms of an Agreement

- for loss or damage to shipments of prohibited items

- for loss, damage, or delay caused by events we cannot control, including but not limited to acts of God, perils of the air, weather conditions, acts of public enemies, war strikes, civil commotions, or acts of public authorities with actual or apparent authority.

Declared Value Limits

- The highest declared value allowed for FedEx Letter and FedEx Pak shipments is \$500.
- For other shipments, the highest declared value allowed is \$50,000 unless your package contains items of "extraordinary value," in which case the highest declared value allowed is \$500.
- Items of "extraordinary value" include shipments containing such items as artwork, jewelry, furs, precious metals, negotiable instruments, and other items listed in our Service Guide.
- You may send more than one package on this airbill and fill in the total declared value for all packages, not to exceed the \$100, \$500 or \$50,000 per package limit described above. (Example: 5 packages can have a total declared value of up to \$250,000.) In that case, our liability is limited to the actual value of the package(s) lost or damaged, but may not exceed the maximum allowable declared value(s) or the total declared value, whichever is less. You are responsible for proving the actual loss or damage.

Filing A Claim YOU MUST MAKE ALL CLAIMS IN WRITING and notify us of your claim within strict time limits set out in the current Service Guide.

We'll consider your claim filed if you notify our Customer Service Department at 1-800-GoFedEx and make your claim in writing as soon as possible.

Within 90 days after you notify us of your claim, you must send us all the information you have about it. We aren't obligated to act on any claim until you have paid all transportation charges, and you may not deduct the amount of your claim from those charges.

If the recipient accepts your package without noting any damage on the delivery record, we will assume the package was delivered in good condition. For us to process your claim, you must make the original shipping cartons and packing available for inspection.

Right To Inspect We may at our option open and inspect your packages before or after you give them to us to deliver.

Right Of Rejection We reserve the right to reject a shipment when such shipment would be likely to cause delay or damage to other shipments, equipment, or personnel or if its shipment is prohibited by law; or if the shipment would violate any terms of our Agreement or our current Service Guide.

C.O.D. Services C.O.D. SERVICE IS NOT AVAILABLE WITH THIS AIRBILL. If C.O.D. Service is required, please use a Federal Express C.O.D. airbill.

Air Transportation Tax Included Our basic rate includes a federal tax required by Internal Revenue Code Section 4271 on the air transportation portion of this service.

Money-Back Guarantee In the event of untimely delivery, Federal Express will at your request and with some limitations, refund or credit all transportation charges. See current Service Guide for more information.

Freight Services There are several freight service options, depending on your transit time needs.

- **FedEx Overnight Freight:** Next business-day service to all points in the 48 states; rates are uniform, regardless of distance shipped.
- **FedEx 2Day Freight:** Second business-day service to all points in the 48 states; rates are uniform, regardless of distance shipped.
- **FedEx Express Saver Freight:** Up to 3 business-day service to all points in the 48 states; rates are based upon the distance shipped.

When recorded, mail to:

Name: George Klinell

Address: 8474 S. Treasure Mtn. Dr.

City/State/Zip Code: Sandy, Utah 84093

ARIZONA
STATE OFFICE
PHOENIX, ARIZONA

SEP 2 8 15 PM '99

RECEIVED
BUREAU OF
LAND MANAGEMENT

Space above this line for Recorder's use

NOTICE OF MINING CLAIM

1. TYPE OF NOTICE: Location Amendment Relocation
2. TYPE OF CLAIM: Placer Lode Millsite Tunnelsite
3. The name and address of the Locator is
Name: George Klinell
Address: 8474 S. Treasure Mtn. Dr.
City/State/Zip Code: Sandy, Utah 84093
4. The name of the claim is ABSM-II-R
5. The date of the location is 2 September 1999
6. The claim is 2640 feet long and 2640 feet wide. The distance from the location monument to each end of the claim is 300 feet in a southerly direction and 3727 feet in a Southeasterly direction.
7. The general course of the claim is from the North to the South
8. The location of the claim is in Section 13, Township 10 North, Range 3 West,
Gila and Salt River Base and Meridian,
Unorganized Mining District, Yavapai County,
State of Arizona
9. If amending or relocating, the previous claim name was _____
recorded in Docket(Book) _____ page(s) _____,
_____ Mining District, _____ County,
State of _____
10. The location of the claim with reference to a natural object or permanent monument is 1620 feet South of Wagoner Junction on State Highway 60, being the Northwest corner of the Southwest 1/4 of the Northwest 1/4 of Section 13.

Dated: 2 September 1999

George Klinell
Signature

8474 S. Treasure Mtn. Dr.
Address

Sandy, Utah 84093
City/State/Zip

City/State/Zip

MAP OF MINING CLAIM LOCATION

1. The name of the claim is ABSM-II-R;
2. The Northwest corner of the claim is 1620 feet in a Southerly direction from a survey monument or permanent natural object described as Wagoner Junction on State Highway 60.
3. The type of location monument is Wood stake, 3 1/2" x 4'
The type of corner end monuments are Wood stake, 3 1/2" x 4'
4. The bearing and distance between the corners of the claim are beginning at the Northwest corner of the claim, 2640 feet in a Southerly direction to the Southwest corner, then 2640 feet in a Easterly direction to the Southeast corner, then 2640 feet in a Northerly direction to the Northeast corner, then 2640 feet in a Westerly direction to the point of beginning.

MAP

One inch = One thousand feet

North Arrow



TWO MILES

TWO MILES

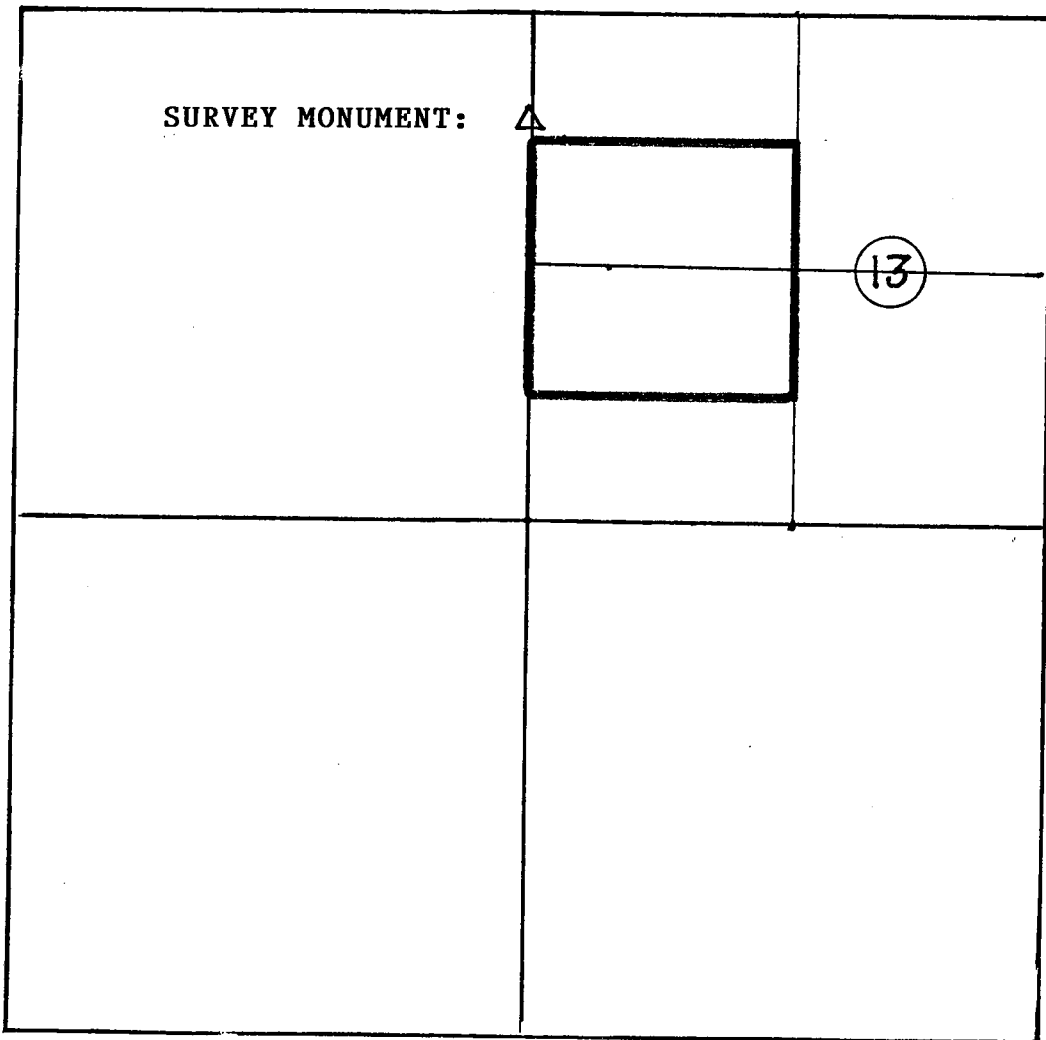

2560 ACRES

Section 13 Range 3 West Township 10 North
Gila and Salt River Base and Meridian.

Dated: 2 SEPTEMBER 1999

George Skindell
Signature

U.S. BUREAU OF LAND MANAGEMENT
Notice of Mining Claim
ABS - I-R

ADDENDUM "A"

<u>Name of Locators:</u>	<u>Address of Locators:</u>
* George Klinell, As Agent ✓	8474 S. Treasure Mtn. Dr. Sandy, Utah 84093
Deanna W. Klinell ✓	8474 S. Treasure Mtn. Dr. Sandy, Utah 84093
Drew J. Klinell ✓	2051 E. Dimple Dell Rd. Sandy, Utah 84092
Don Kline ✓	13122 Ranchwood Rd. Tustin, Ca. 92782
Don Jares ✓	6321 Mori St. Mc Lean, Va. 22101
Hal J. Brostrom ✓	1815 N. Kensington Farmington, Ut. 84025
Clark Brown ✓	2184 W. Gentile Layton, Ut. 84041
John Pease ✓	4432 W. 5820 S. Kearns, Ut. 84118

* Lead Owner

ARIZONA
STATE OFFICE
PHOENIX, ARIZONA

SEP 2 8 15 PM '99

RECEIVED
BUREAU OF
LAND MANAGEMENT

400 282455

RECEIVED
BUREAU OF
LAND MANAGEMENT

SEP 2 8 15 PM '99

ARIZONA
STATE OFFICE
PHOENIX, ARIZONA

When recorded, mail to:

Name: George Klinell

Address: 8474 S. Treasure Mtn. Dr.

City/State/Zip Code: Sandy, Utah 84093

Space above this line for Recorder's use

NOTICE OF MINING CLAIM

- 1. TYPE OF NOTICE: Location Amendment Relocation
- 2. TYPE OF CLAIM: Placer Lode Millsite Tunnelsite

3. The name and address of the Locator is

Name: George Klinell

Address: 8474 S. Treasure Mtn. Dr.

City/State/Zip Code: Sandy, Utah 84093

4. The name of the claim is ABSM-I-R

5. The date of the location is 2 September 1999

6. The claim is 2640 feet long and 2640 feet wide. The distance from the location monument to each end of the claim is 2940 feet in a southerly direction and 4000 feet in a southeasterly direction.

7. The general course of the claim is from the North to the South.

8. The location of the claim is in Sections 13 and 24, Township 10 North, Range 3 West.

Gila and Salt River Base and Meridian,

State of Unorganized Arizona Mining District, Yavapai County,

9. If amending or relocating, the previous claim name was N/A

recorded in Docket(Book) _____ page(s) _____,

_____ Mining District, _____ County,

State of _____

10. The location of the claim with reference to a natural object or permanent monument is 2940 feet South of Wagoner Junction on State Highway 60, being the NW corner of the southern 1/2 of the SW 1/4 of Section 13, T10N, R3W.

Dated: 2 September 1999

George Klinell
Signature

8474 S. Treasure Mtn. Dr.
Address

Sandy, Utah 84093
City/State/Zip

MAP OF MINING CLAIM LOCATION

1. The name of the claim is ABSM - I-R;
2. The Northwest corner of the claim is 2940 feet in a Southerly direction from a survey monument or permanent natural object described as Wagoner Junction on State Highway 60.
3. The type of location monument is wood stake, 3 1/2" x 4'
The type of corner end monuments are wood stakes, 3 1/2" x 4'
4. The bearing and distance between the corners of the claim are beginning at the Northwest corner of the claim, 2640 feet in a ⁿ Easterly direction to the Southwest corner, then 2640 feet in a Northerly direction to the Northeast corner, then 2640 feet in a Westerly direction to the _____ corner, then _____ feet in a _____ direction to the point of beginning.

MAP

One inch = One thousand feet

North Arrow



TWO MILES

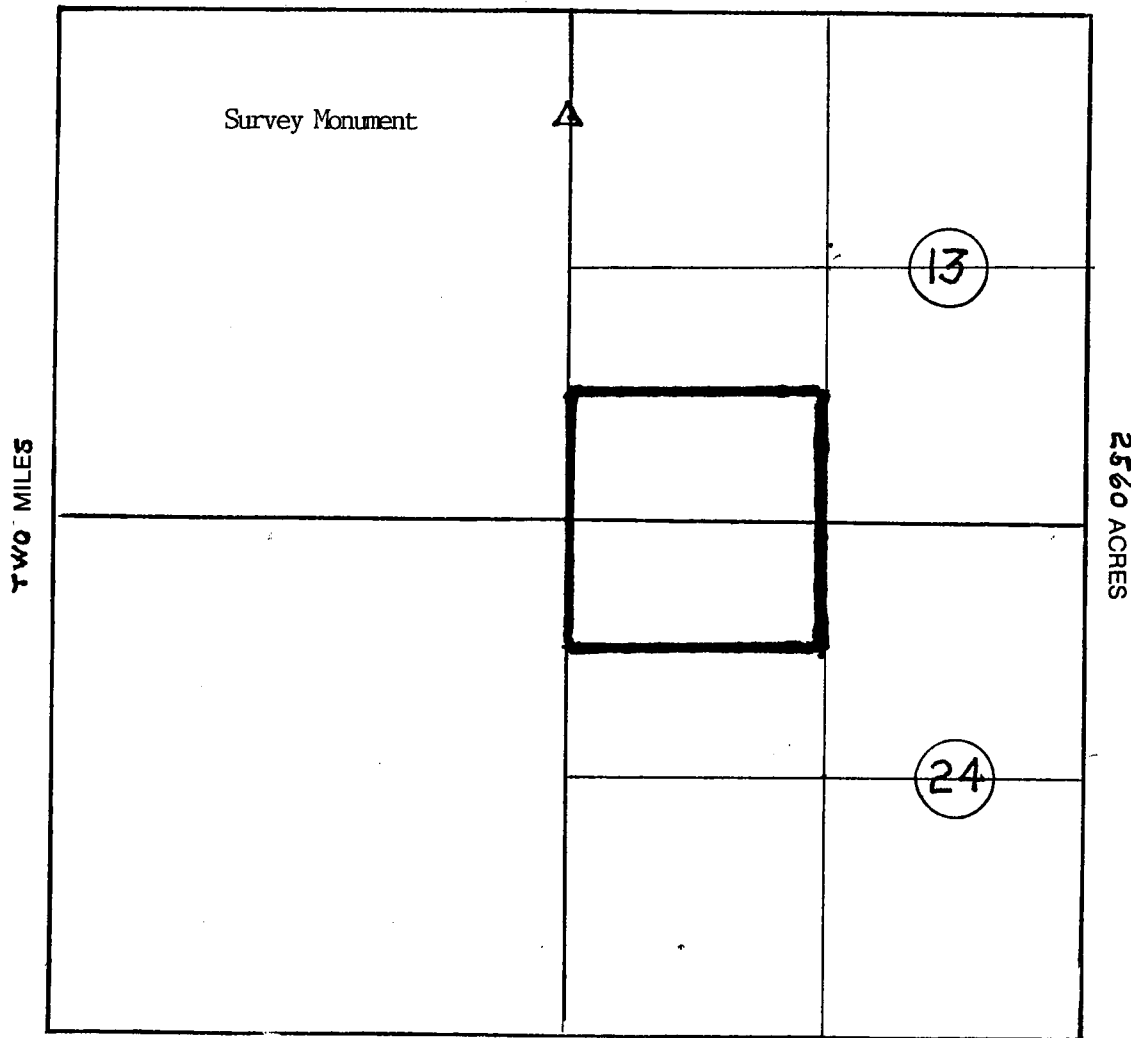

Section 13 and 24 Range 3 West Township 10 North,
Giula and Salt River Base and Meridian.

Dated: 2 September 1999

George Kinell
Signature

U.S. BUREAU OF LAND MANAGEMENT
Notice of Mining Claim
ABS -II-R

ADDENDUM "A"

<u>Name of Locators:</u>	<u>Address of Locators:</u>
* George Klinell, As Agent	8474 S. Treasure Mtn. Dr. Sandy, Utah 84093
Deanna W. Klinell	8474 S. Treasure Mtn. Dr. Sandy, Utah 84093
Drew J. Klinell	2051 E. Dimple Dell Rd. Sandy, Utah 84092
Don Kline	13122 Ranchwood Rd. Tustin, Ca. 92782
Don Jares	6321 Mori St. Mc Lean, Va. 22101
Hal J. Brostrom	1815 N. Kensington Farmington, Ut. 84025
Clark Brown	2184 W. Gentile Layton, Ut. 84041
John Pease	4432 W. 5820 S. Kearns, Ut. 84118

* Lead Owner

A MC 352456

ARIZONA
STATE OFFICE
PHOENIX, ARIZONA

SEP 2 8 15 PM '99

RECEIVED
BUREAU OF
LAND MANAGEMENT

The United States of America,

To all to whom these presents shall come, Greeting:

WHEREAS, under the provisions of Section 8 of the Act of June 28, 1934 (48 Stat. 1269), entitled "An Act To stop injury to the public grazing lands by preventing overgrazing and soil deterioration, to provide for their orderly use, improvement, and development, to stabilize the livestock industry dependent upon the public range, and for other purposes," as amended by Section 3 of the Act of June 26, 1936 (49 Stat. 1978), the State of Arizona, in exchange for certain other land situated in said State, has selected the west half of the southeast quarter of Section twelve and the northwest quarter of the northeast quarter, the southeast quarter of the northwest quarter and the east half of the southeast quarter of Section thirteen in Township ten north of Range three west of the Gila and Salt River Meridian, Arizona, containing two hundred forty acres, according to the Official Plat of the Survey of the said Land, on file in the GENERAL LAND OFFICE:

NOW KNOW YE, That the UNITED STATES OF AMERICA, in consideration of the premises, and in conformity with the said Acts of Congress, HAS GIVEN AND GRANTED, and by these presents DOES GIVE AND GRANT, unto the said State of Arizona, in fee simple, the tract of land above described; TO HAVE AND TO HOLD the same, together with all the rights, privileges, immunities, and appurtenances, of whatsoever nature thereunto belonging, unto the said State of Arizona, and to its assigns forever; subject to any vested and accrued water rights for mining, agricultural, manufacturing, or other purposes, and rights to ditches and reservoirs used in connection with such water rights, as may be recognized and acknowledged by the local customs, laws, and decisions of courts; and there is reserved from the lands hereby granted, a right of way thereon for ditches or canals constructed by the authority of the United States. Reserving, also, to the United States, all minerals in the lands so granted, together with the right to prospect for, mine and remove the same, as authorized by the provisions of said section 8, as amended as aforesaid. Reserving unto the United States, its permittee or licensee, the right to enter upon, occupy and use, any part or all of said lands, for the purposes provided in the Act of June 10, 1920 (41 Stat. 1063), and subject to the conditions and limitations of Section 24 of said Act, as amended by the Act of August 26, 1935 (49 Stat. 846).

IN TESTIMONY WHEREOF, I, **Franklin D. Roosevelt,**

President of the United States of America, have caused these letters to be made

Patent, and the Seal of the General Land Office to be hereunto affixed.

GIVEN under my hand, at the City of Washington, the **TWENTY-THIRD**

[SEAL]

day of **AUGUST** in the year of our Lord one thousand

nine hundred and **FORTY-FOUR** and of the Independence of the

United States the one hundred and **SIXTY-NINTH**

By the President:

Franklin D. Roosevelt

By

Ruth W. Talley
R. Schlichter

Secretary.

COPY

COPY

UNITED STATES
DEPARTMENT OF THE INTERIOR
GENERAL LAND OFFICE

RECEIVED
U.S. LAND OFFICE
Phoenix, Arizona

1965518 "F"

WASHINGTON 25, D.C.

OCT 15 1943

OCT. 7-1943

: Restoration under Section 24,
: Federal Power Act - No. 1153.

MEMORANDUM for the Register,
District Land Office,
Phoenix, Arizona.

3-19-43

By Executive Order of July 2, 1910, certain lands within your district were withdrawn and included in Power Site Reserve No. 96, and by letter of notification of December 15, 1924, were reserved from entry, location, or other disposal and included in Power Project No. 306.

The Federal Power Commission has determined that the value of the N $\frac{1}{2}$ NE $\frac{1}{4}$, SE $\frac{1}{2}$ NE $\frac{1}{4}$, N $\frac{1}{2}$ SE $\frac{1}{4}$, sec. 15, T. 10 N., R. 3 W.G. and S.R.M., Arizona, would not be injured or destroyed for purposes of power development by location, entry, or selection under the public land laws, subject to the provisions of Section 24 of the Federal Power Act, as amended.

Pursuant to the determination by the Federal Power Commission and in accordance with Departmental Order No. 1799 of March 19, 1943 the above-described lands are hereby declared open to disposition under the public land laws, subject, however, to all valid rights, existing withdrawals, and the terms and conditions of Section 24 of the Federal Power Act, as amended.

Any application for the lands should be made subject to the following reservation:

"Made in accordance with and subject to the provisions and reservations of Section 24 of the Federal Power Act of June 10, 1920 (41 Stat. 1063), as amended by the act of August 26, 1935 (49 Stat. 846)."

Make proper notations upon the records of your office and acknowledge receipt hereof.

/S/ FRED W. JOHNSON
Commissioner.

C
O
P
Y

DEPARTMENT OF THE INTERIOR
UNITED STATES GEOLOGICAL SURVEY

Washington
Office Of The Director

January 3, 1910

The Honorable,
The Secretary of the Interior.

Sir:

In accordance with your instructions of April 23, 1909,
I have the honor to submit the following recommendation, which
involves 1,800 acres, 280 acres being entered:

TEMPORARY POWER SITE WITHDRAWAL NO. 96

Hassayampa Creek, Arizona.

In aid of proposed legislation affecting the disposal of
water power sites on the public domain, all public lands in the
following list are temporarily withdrawn from all forms of entry,
selection, disposal, settlement, or location, and all existing claims,
heretofore made may proceed up to and including the submission of
final proof, but no purchase money will be received or final certifi-
cate of entry issued until further orders.

Gila and Salt River Meridian.

- T. 10 N., R. 3 W., Sec. 2, SW $\frac{1}{4}$ of SE $\frac{1}{4}$;
- Sec. 10, SW $\frac{1}{4}$ of SE $\frac{1}{4}$;
- Sec. 11, SE $\frac{1}{4}$ of SE $\frac{1}{4}$;
- Sec. 12, W $\frac{1}{2}$ of W $\frac{1}{2}$, W $\frac{1}{2}$ of SE $\frac{1}{4}$;

The Honorable p.2

T. 10 N., R. 3 W., (con't)

Sec. 13, NW $\frac{1}{4}$ of NE $\frac{1}{4}$, S $\frac{1}{2}$ of NW $\frac{1}{4}$, SW $\frac{1}{4}$;
Sec. 14, SW $\frac{1}{4}$ of NE $\frac{1}{4}$, W $\frac{1}{2}$ of NW $\frac{1}{4}$, SE $\frac{1}{4}$
of NW $\frac{1}{4}$, SW $\frac{1}{4}$ of SW $\frac{1}{4}$, SE $\frac{1}{4}$ of
SE $\frac{1}{4}$;
Sec. 15, E $\frac{1}{2}$ of E $\frac{1}{2}$, NW $\frac{1}{4}$ of NE $\frac{1}{4}$, NW $\frac{1}{4}$
of SE $\frac{1}{4}$;
Sec. 22, E $\frac{1}{2}$ of NE $\frac{1}{4}$;
Sec. 23, NE $\frac{1}{4}$ of NE $\frac{1}{4}$, NW $\frac{1}{4}$ of NW $\frac{1}{4}$, S $\frac{1}{2}$
of N $\frac{1}{2}$, N $\frac{1}{2}$ of SW $\frac{1}{4}$, NW $\frac{1}{4}$ of SE $\frac{1}{4}$;
Sec. 24, N $\frac{1}{2}$ of NE $\frac{1}{4}$, NW $\frac{1}{4}$.

Very respectfully,

/s/ Geo. Otis Smith

Director

Approved January 6, 1910
and sent to General Land Office

/s/ R. A. Ballinger
Secretary

Certified to be a true
copy of the original

Quinn T. Miller
Certifying Officer

Run Date: 10/08/1999
RUN TIME:12:05 PM

UNITED STATES DEPARTMENT OF INTERIOR
BUREAU OF LAND MANAGEMENT

Page: 1

STATE: AZ

GEOGRAPHIC REPORT WITH LAND

<u>CASETYPE</u>	<u>CASE DISP</u>	<u>MER</u>	<u>TWP</u>	<u>RNG</u>	<u>SECT</u>	<u>SUR TYP</u>	<u>SUR NR</u>	<u>SUF</u>	<u>SUBDIVISION</u>
Serial Number: AZA 014950									
Total Case Acres: 1,200.000									
311111	CLOSED	14	0100N	0030W	010	A			SW,SWSE;
					011	A			SESE;
					012	A			SWSW,W2E2,E2SE;
					013	A			NE;
					014	A			W2NW,SENW,SWNE;
					015	A			W2,SWSE;
Serial Number: AZA 016997									
Total Case Acres: 3,450.750									
272011	AUTHORIZED	14	0100N	0030W	010	A			SESW;
					015	A			NENW,S2NW,SWSE,SW;
					017	A			SWNE,S2NW,SW,W2SE;
						L			2;
					018	A			SE;
					019	A			N2NE;
					020	A			ALL;
					021	A			S2,NW,W2NE;
					025	A			E2SW,SENW;
						L			3;
					027	A			SWNE,S2NW,NESW;
					028	A			S2NW,NWNW,S2NE,N2SE,SW;

Run Date: 10/08/1999
RUN TIME:12:05 PM

UNITED STATES DEPARTMENT OF INTERIOR
BUREAU OF LAND MANAGEMENT

Page: 2

STATE: AZ

GEOGRAPHIC REPORT WITH LAND

<u>CASETYPE</u>	<u>CASE DISP</u>	<u>MER</u>	<u>TWP</u>	<u>RNG</u>	<u>SECT</u>	<u>SUR TYP</u>	<u>SUR NR</u>	<u>SUF</u>	<u>SUBDIVISION</u>
					029	A			NE;
					030	A			NE,E2SE;
						L			1,2;
Serial Number: AZA 019332									
Total Case Acres: 4.000									
282201	AUTHORIZED	14	0100N	0030W	013	A			W2SW;
					024	A			NW;
Serial Number: AZA 024411									
Total Case Acres: 7,284.000									
272011	AUTHORIZED	14	0100N	0030W	005	A			SWSW;
						L			3-6,9-11;
					006	A			S2NE,N2SE,SWSE;
						L			1,2,5,6,10;
					007	A			E2;
					008	A			SWNE,S2NW,N2SW,W2SE;
						L			1,2,5-7;
					017	A			NWNE,N2NW;
						L			1;
					018	A			N2NE,SWNE;

Run Date: 10/08/1999
RUN TIME:12:05 PM

UNITED STATES DEPARTMENT OF INTERIOR
BUREAU OF LAND MANAGEMENT

Page: 3

STATE: AZ

GEOGRAPHIC REPORT WITH LAND

<u>CASETYPE</u>	<u>CASE DISP</u>	<u>MER</u>	<u>TWP</u>	<u>RNG</u>	<u>SECT</u>	<u>SUR TYP</u>	<u>SUR NR</u>	<u>SUF</u>	<u>SUBDIVISION</u>
					718	L			2;
Serial Number: AZA 026166									
Total Case Acres: 1.000									
380913	AUTHORIZED	14	0100N	0030W	032		1	1	PORTIONS OF NESW;
Serial Number: AZA 026497									
Total Case Acres: 1.000									
380913	AUTHORIZED	14	0100N	0030W	011	A			SESE;
					012	1		1	PART OF SE;
						A			SWSW;
Serial Number: AZA 026580									
Total Case Acres: 4,838.370									
272011	AUTHORIZED	14	0100N	0030W	010	A			NESW,SWSE;
					011	A			SESE;
					012	A			SWSW;
					014	A			NWNW,S2NW;
					024	A			NE;
					025	1		1	POR LOTS 3-4,S2N2,S2;

Run Date: 10/08/1999
RUN TIME:12:05 PM

UNITED STATES DEPARTMENT OF INTERIOR
BUREAU OF LAND MANAGEMENT

Page: 4

STATE: AZ

GEOGRAPHIC REPORT WITH LAND

<u>CASETYPE</u>	<u>CASE DISP</u>	<u>MER</u>	<u>TWP</u>	<u>RNG</u>	<u>SECT</u>	<u>SUR TYP</u>	<u>SUR NR</u>	<u>SUF</u>	<u>SUBDIVISION</u>
					702	A			S2NE,E2SW,N2SE,SESE;
						L			1-2;
					711	1		1	M&B IN ALL EXC SESE;
					713	A			S2SE;

Serial Number: AZA 027551

Total Case Acres: 1.000

380913	CLOSED	14	0100N	0030W	025	1		1	PART;
					026	1		1	PART;

Serial Number: AZA 027579

Total Case Acres: 1.000

380913	CLOSED	14	0100N	0030W	013	1		1	PART;
--------	--------	----	-------	-------	-----	---	--	---	-------

Serial Number: AZA 028204

Total Case Acres: 520.000

272011	AUTHORIZED	14	0100N	0030W	012	A			W2NE,E2SE;
					013	A			NENE,S2NE;
					024	A			E2SW,SE;

Run Date: 10/08/1999
RUN TIME:12:05 PM

UNITED STATES DEPARTMENT OF INTERIOR
BUREAU OF LAND MANAGEMENT

STATE: AZ

GEOGRAPHIC REPORT WITH LAND

<u>CASETYPE</u>	<u>CASE DISP</u>	<u>MER</u>	<u>TWP</u>	<u>RNG</u>	<u>SECT</u>	<u>SUR TYP</u>	<u>SUR NR</u>	<u>SUF</u>	<u>SUBDIVISION</u>
-----------------	------------------	------------	------------	------------	-------------	----------------	---------------	------------	--------------------

Serial Number: AZA 028766

Total Case Acres: 1.000

380913	AUTHORIZED	14	0100N	0030W	024	A			NW;
--------	------------	----	-------	-------	-----	---	--	--	-----

Serial Number: AZA 030288

Total Case Acres: 1.000

380913	PENDING	14	0100N	0030W	024	A			W2;
--------	---------	----	-------	-------	-----	---	--	--	-----

UNITED STATES DEPARTMENT OF THE INTERIOR
 BUREAU OF LAND MANAGEMENT
 LIST OF MINING CLAIMS BY SECTION

**MER TWP RNG SEC
 14 0100N 0030W 013**

<u>SERIAL NUM</u>	<u>QUAD</u>	<u>CLAIM NAME</u>	<u>CLAIMANT</u>	<u>LEAD FILE</u>	<u>CASE TYPE</u>	<u>STATUS</u>	<u>LOC DATE</u>	<u>LAST ASSESSMENT</u>
AMC100792	NW SW	GOLDEN NUGGET #5	COX LESTER	100788	384101	CLOSED	01/14/1980	1988
			FRYE VALDON	100788	384101	CLOSED	01/14/1980	1988
AMC100793	NW SW	GOLDEN NUGGET #6	COX LESTER	100788	384101	CLOSED	01/14/1980	1988
			FRYE VALDON	100788	384101	CLOSED	01/14/1980	1988
AMC100794	NW SW	GOLDEN NUGGET #7	COX LESTER	100788	384101	CLOSED	01/14/1980	1988
			FRYE VALDON	100788	384101	CLOSED	01/14/1980	1988
AMC107546	NW	BIT-OF-HOPE	COOPER DORIS		384201	CLOSED	06/27/1980	1981
			COOPER NEL		384201	CLOSED	06/27/1980	1981
			COOPER ROBERT D		384201	CLOSED	06/27/1980	1981
AMC107547	SW	BIT-HOPE #2	COOPER DENIS	107546	384201	CLOSED	07/03/1980	1981
			COOPER DORIS	107546	384201	CLOSED	07/03/1980	1981
			COOPER NEL	107546	384201	CLOSED	07/03/1980	1981
			COOPER ROBERT D	107546	384201	CLOSED	07/03/1980	1981
AMC116708	SW	BIT OF HOPE #3	COOPER DORIS		384201	CLOSED	11/20/1980	1981
			COOPER ROBERT		384201	CLOSED	11/20/1980	1981
AMC116709	SW	BIT OF HOPE #4	COOPER DORIS	116708	384201	CLOSED	11/20/1980	1981
			COOPER ROBERT	116708	384201	CLOSED	11/20/1980	1981
AMC116710	NW	BIT OF HOPE #5	COOPER DORIS	116708	384201	CLOSED	11/20/1980	1981
			COOPER ROBERT	116708	384201	CLOSED	11/20/1980	1981
AMC116711	SE	BIT OF HOPE #6	COOPER DORIS	116708	384201	CLOSED	11/20/1980	1981
			COOPER ROBERT	116708	384201	CLOSED	11/20/1980	1981
AMC128043	NW SW	GOLDEN NUGGET #5	COX LESTER		384201	CLOSED	04/16/1981	1988
AMC128044	NW SW	GOLDEN NUGGET #6	COX LESTER		384201	CLOSED	04/16/1981	1988
AMC128045	NW SW	GOLDEN NUGGET #7	COX LESTER		384201	CLOSED	04/16/1981	1988
AMC128046	NW SW	GOLDEN NUGGET #5	COX LESTER		384101	CLOSED	04/16/1981	1988
AMC128047	NW SW	GOLDEN NUGGET #6	COX LESTER		384101	CLOSED	04/16/1981	1988
AMC128048	NW SW	GOLDEN NUGGET #7	COX LESTER		384101	CLOSED	04/16/1981	1988
AMC147609	NE	PAY U SOMETIME #2	BLAND JOHN	147608	384101	CLOSED	10/01/1981	0000
			CALKINS DONALD	147608	384101	CLOSED	10/01/1981	0000

UNITED STATES DEPARTMENT OF THE INTERIOR
 BUREAU OF LAND MANAGEMENT
 LIST OF MINING CLAIMS BY SECTION

<u>SERIAL NUM</u>	<u>QUAD</u>	<u>CLAIM NAME</u>	<u>CLAIMANT</u>	<u>LEAD FILE</u>	<u>CASE TYPE</u>	<u>STATUS</u>	<u>LOC DATE</u>	<u>LAST ASSESSMENT</u>
			COOPER DORIS	147608	384101	CLOSED	10/01/1981	0000
			COOPER NEL	147608	384101	CLOSED	10/01/1981	0000
			COOPER REX	147608	384101	CLOSED	10/01/1981	0000
			COOPER ROBERT D	147608	384101	CLOSED	10/01/1981	0000
			GREEN BILL	147608	384101	CLOSED	10/01/1981	0000
			WEBBER ROGER	147608	384101	CLOSED	10/01/1981	0000
AMC147610	NE	PAY U SOMETIME #3	BLAND JOHN	147608	384101	CLOSED	10/01/1981	0000
			CALKINS DONALD	147608	384101	CLOSED	10/01/1981	0000
			COOPER DORIS	147608	384101	CLOSED	10/01/1981	0000
			COOPER NEL	147608	384101	CLOSED	10/01/1981	0000
			COOPER REX	147608	384101	CLOSED	10/01/1981	0000
			COOPER ROBERT D	147608	384101	CLOSED	10/01/1981	0000
			GREEN BILL	147608	384101	CLOSED	10/01/1981	0000
			WEBBER ROGER	147608	384101	CLOSED	10/01/1981	0000
AMC194259	SW	LOST NUGGET #2	MANTIE BETSY	194258	384201	CLOSED	04/13/1983	0000
			SCHULER JANET	194258	384201	CLOSED	04/13/1983	0000
AMC201501	NW	PAY U SOMETIME #1	COOPER DORIS	201498	384201	CLOSED	07/20/1983	1992
			COOPER ROBERT	201498	384201	CLOSED	07/20/1983	1992
			DAVIS BARBARA L	201498	384201	CLOSED	07/20/1983	1992
			GREEN BILL	201498	384201	CLOSED	07/20/1983	1992
AMC201502	NW	PAY U SOMETIME #2	COOPER DORIS	201498	384201	CLOSED	07/18/1983	1992
			COOPER ROBERT	201498	384201	CLOSED	07/18/1983	1992
			DAVIS BARBARA L	201498	384201	CLOSED	07/18/1983	1992
			GREEN BILL	201498	384201	CLOSED	07/18/1983	1992
AMC201503	NE	PAY U SOMETIME #3	COOPER DORIS	201498	384201	CLOSED	07/20/1983	1992
			COOPER ROBERT	201498	384201	CLOSED	07/20/1983	1992
			GREEN BILL	201498	384201	CLOSED	07/20/1983	1992
			GREEN WANDA	201498	384201	CLOSED	07/20/1983	1992
AMC211061	NW	BIT OF HOPE #1	COOPER DORIS		384201	CLOSED	12/01/1983	1992
			COOPER ROBERT		384201	CLOSED	12/01/1983	1992
AMC211062	SW	BIT OF HOPE #2	COOPER DORIS	211061	384201	CLOSED	12/01/1983	1992
			COOPER ROBERT	211061	384201	CLOSED	12/01/1983	1992
AMC211063	SW	BIT OF HOPE #3	COOPER DORIS	211061	384201	CLOSED	12/01/1983	1992

UNITED STATES DEPARTMENT OF THE INTERIOR
 BUREAU OF LAND MANAGEMENT
 LIST OF MINING CLAIMS BY SECTION

<u>SERIAL NUM</u>	<u>QUAD</u>	<u>CLAIM NAME</u>	<u>CLAIMANT</u>	<u>LEAD FILE</u>	<u>CASE TYPE</u>	<u>STATUS</u>	<u>LOC DATE</u>	<u>LAST ASSESSMENT</u>
			COOPER ROBERT	211061	384201	CLOSED	12/01/1983	1992
AMC211064	SW	BIT OF HOPE #4	COOPER DORIS	211061	384201	CLOSED	12/01/1983	1992
			COOPER ROBERT	211061	384201	CLOSED	12/01/1983	1992
AMC211065	NW	BIT OF HOPE #5	COOPER DORIS	211061	384201	CLOSED	12/01/1983	1992
			COOPER ROBERT	211061	384201	CLOSED	12/01/1983	1992
AMC211066	SE	BIT OF HOPE #6	COOPER DORIS	211061	384201	CLOSED	12/02/1983	1984
			COOPER ROBERT	211061	384201	CLOSED	12/02/1983	1984
AMC299176	NE NW	EIGHTY NINER	HARMAN A D	299176	384201	CLOSED	10/01/1989	0000
			HARPER H L	299176	384201	CLOSED	10/01/1989	0000
			HARPER TIM	299176	384201	CLOSED	10/01/1989	0000
			MOBLEY GARY	299176	384201	CLOSED	10/01/1989	0000
			MOBLEY N E	299176	384201	CLOSED	10/01/1989	0000
			MOBLEY ROY	299176	384201	CLOSED	10/01/1989	0000
			MOBLEY RUTH	299176	384201	CLOSED	10/01/1989	0000
			SCHUFLETOWSKI CHARLE	299176	384201	CLOSED	10/01/1989	0000
AMC304279	NW	WAGNER #1	HARPER H L	304274	384101	CLOSED	05/06/1990	0000
			WHEELER MAX	304274	384101	CLOSED	05/06/1990	0000
AMC304280	NW	WAGNER #2	HARPER H L	304274	384101	CLOSED	05/06/1990	0000
			WHEELER MAX	304274	384101	CLOSED	05/06/1990	0000
AMC304281	NW	WAGNER #3	HARPER H L	304274	384101	CLOSED	05/06/1990	0000
			WHEELER MAX	304274	384101	CLOSED	05/06/1990	0000
AMC321085	NE SE	TIEMPO DE JUEGO #1	GILLARD GARY	321085	384201	CLOSED	04/19/1992	0000
			GILLARD SHIRLEY	321085	384201	CLOSED	04/19/1992	0000
			SMITH JANIE	321085	384201	CLOSED	04/19/1992	0000
			SMITH QUINCY	321085	384201	CLOSED	04/19/1992	0000
AMC348459	NW SW	ABSM - I	BROSTROM HAL J	AMC348459-AM	384201	ACTIVE	11/01/1997	1999
			BROWN CLARK	AMC348459-AM	384201	ACTIVE	11/01/1997	1999
			JARES DON	AMC348459-AM	384201	ACTIVE	11/01/1997	1999
			KLINE DON	AMC348459-AM	384201	ACTIVE	11/01/1997	1999
			KLINELL DEANNA W	AMC348459-AM	384201	ACTIVE	11/01/1997	1999
			KLINELL DREW J	AMC348459-AM	384201	ACTIVE	11/01/1997	1999
			KLINELL GEORGE	AMC348459-AM	384201	ACTIVE	11/01/1997	1999
			PEASE JOHN	AMC348459-AM	384201	ACTIVE	11/01/1997	1999

UNITED STATES DEPARTMENT OF THE INTERIOR
 BUREAU OF LAND MANAGEMENT
 LIST OF MINING CLAIMS BY SECTION

<u>SERIAL NUM</u>	<u>QUAD</u>	<u>CLAIM NAME</u>	<u>CLAIMANT</u>	<u>LEAD FILE</u>	<u>CASE TYPE</u>	<u>STATUS</u>	<u>LOC DATE</u>	<u>LAST ASSESSMENT</u>
AMC348460	NW SW	ABSM - II	BROSTROM HAL J	AMC348459	384201	ACTIVE	11/01/1997	1999
			BROWN CLARK	AMC348459	384201	ACTIVE	11/01/1997	1999
			JARES DON	AMC348459	384201	ACTIVE	11/01/1997	1999
			KLINE DON	AMC348459	384201	ACTIVE	11/01/1997	1999
			KLINELL DEANNA W	AMC348459	384201	ACTIVE	11/01/1997	1999
			KLINELL DREW J	AMC348459	384201	ACTIVE	11/01/1997	1999
			KLINELL GEORGE	AMC348459	384201	ACTIVE	11/01/1997	1999
			PEASE JOHN	AMC348459	384201	ACTIVE	11/01/1997	1999
AMC348461	NW SW	ABSM - III	BROSTROM HAL J	AMC348459	384201	ACTIVE	11/01/1997	1999
			BROWN CLARK	AMC348459	384201	ACTIVE	11/01/1997	1999
			JARES DON	AMC348459	384201	ACTIVE	11/01/1997	1999
			KLINE DON	AMC348459	384201	ACTIVE	11/01/1997	1999
			KLINELL DEANNA W	AMC348459	384201	ACTIVE	11/01/1997	1999
			KLINELL DREW J	AMC348459	384201	ACTIVE	11/01/1997	1999
			KLINELL GEORGE	AMC348459	384201	ACTIVE	11/01/1997	1999
			PEASE JOHN	AMC348459	384201	ACTIVE	11/01/1997	1999

AZ-1274-4
(June 1987)

DEPARTMENT OF THE INTERIOR
BUREAU OF LAND MANAGEMENT
ARIZONA STATE OFFICE

EXAMINATION OF CASE FILE

A SEPARATE FORM MUST BE COMPLETED FOR EACH LEAD SERIAL NUMBER:

SERIAL NUMBER 352455	TYPE OF CASE MINING CLAIM
-----------------------------	----------------------------------

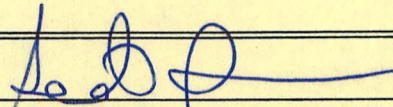
I  HAVE READ AND UNDERSTOOD THE WARNINGS RELATIVE TO TITLE 18 U.S.C. 1001 AND 2071 PRINTED ON THIS FORM AND REQUEST TO EXAMINE THE CASE RECORD BEARING THE ABOVE SERIAL NUMBER OR NAME. I AGREE NOT TO REMOVE OR ALTER THE CONTENTS OF THIS FILE IN ANY MANNER WHATSOEVER AND NOT TO REMOVE THE FILE FROM THE ROOM DESIGNATED FOR PUBLIC EXAMINATION OF SUCH RECORDS.

NAME: SCOTT DONALDSON	DATE: 6/2/00
ADDRESS: 5050 N. 19 th AVE. #409	
P.O. BOX A2 85015-3209	

(PLEASE PRINT INCLUDING ZIP CODE)

- WARNING -

Title 18 U.S. Code 1001. Statements or entries generally

Whoever, in any manner within the jurisdiction of any department or agency of the United States knowingly and willfully falsifies, conceals or covers up by any trick, scheme, or a device a material fact, or makes any false, fictitious or fraudulent statements or representations, or makes or uses any false writing or document knowing the same to contain any false, fictitious or fraudulent statement or entry, shall be fined not more than \$10,000 or imprisoned not more than five years, or both.

- Warning -

Title 18 U.S. Code 2071. Concealment, removal or mutilation generally

Whoever, willfully and unlawfully conceals, removes, mutilates, obliterates, or destroys, or attempts to do so, or, with intent to do so takes and carries away any record, proceeding, map book, paper, document, or other thing, filed or deposited with any clerk or officer of any court of the United States, or in any public office, or with any judicial or public officer of the United States, shall be fined not more than \$2,000 or imprisoned not more than three years.

AZ-1274-4
(June 1987)

DEPARTMENT OF THE INTERIOR
BUREAU OF LAND MANAGEMENT
ARIZONA STATE OFFICE

EXAMINATION OF CASE FILE

A SEPARATE FORM MUST BE COMPLETED FOR EACH LEAD SERIAL NUMBER:

SERIAL NUMBER	TYPE OF CASE
352 455	MINING CLAIM

I Emanuel A. Flores HAVE READ AND UNDERSTOOD THE WARNINGS RELATIVE TO TITLE 18 U.S.C. 1001 AND 2071 PRINTED ON THIS FORM AND REQUEST TO EXAMINE THE CASE RECORD BEARING THE ABOVE SERIAL NUMBER OR NAME. I AGREE NOT TO REMOVE OR ALTER THE CONTENTS OF THIS FILE IN ANY MANNER WHATSOEVER AND NOT TO REMOVE THE FILE FROM THE ROOM DESIGNATED FOR PUBLIC EXAMINATION OF SUCH RECORDS.

NAME: EMANUEL A. FLORES	DATE: 2-17-00
ADDRESS: 2936 S. SIERRA POINT BLVD	
SALT LAKE CITY UTAH 84109	

(PLEASE PRINT INCLUDING ZIP CODE)

- WARNING -

Title 18 U.S. Code 1001. Statements or entries generally

Whoever, in any manner within the jurisdiction of any department or agency of the United States knowingly and willfully falsifies, conceals or covers up by any trick, scheme, or a device a material fact, or makes any false, fictitious or fraudulent statements or representations, or makes or uses any false writing or document knowing the same to contain any false, fictitious or fraudulent statement or entry, shall be fined not more than \$10,000 or imprisoned not more than five years, or both.

- Warning -

Title 18 U.S. Code 2071. Concealment, removal or mutilation generally

Whoever, willfully and unlawfully conceals, removes, mutilates, obliterates, or destroys, or attempts to do so, or, with intent to do so takes and carries away any record, proceeding, map book, paper, document, or other thing, filed or deposited with any clerk or officer of any court of the United States, or in any public office, or with any judicial or public officer of the United States, shall be fined not more than \$2,000 or imprisoned not more than three years.

TOWNSHIP 10 NORTH RANGE 3 WEST OF THE GILA AND SALT RIVER MERIDIAN, ARIZONA

YAVAPAI COUNTY

STATUS OF PUBLIC DOMAIN
LAND AND MINERAL TITLES

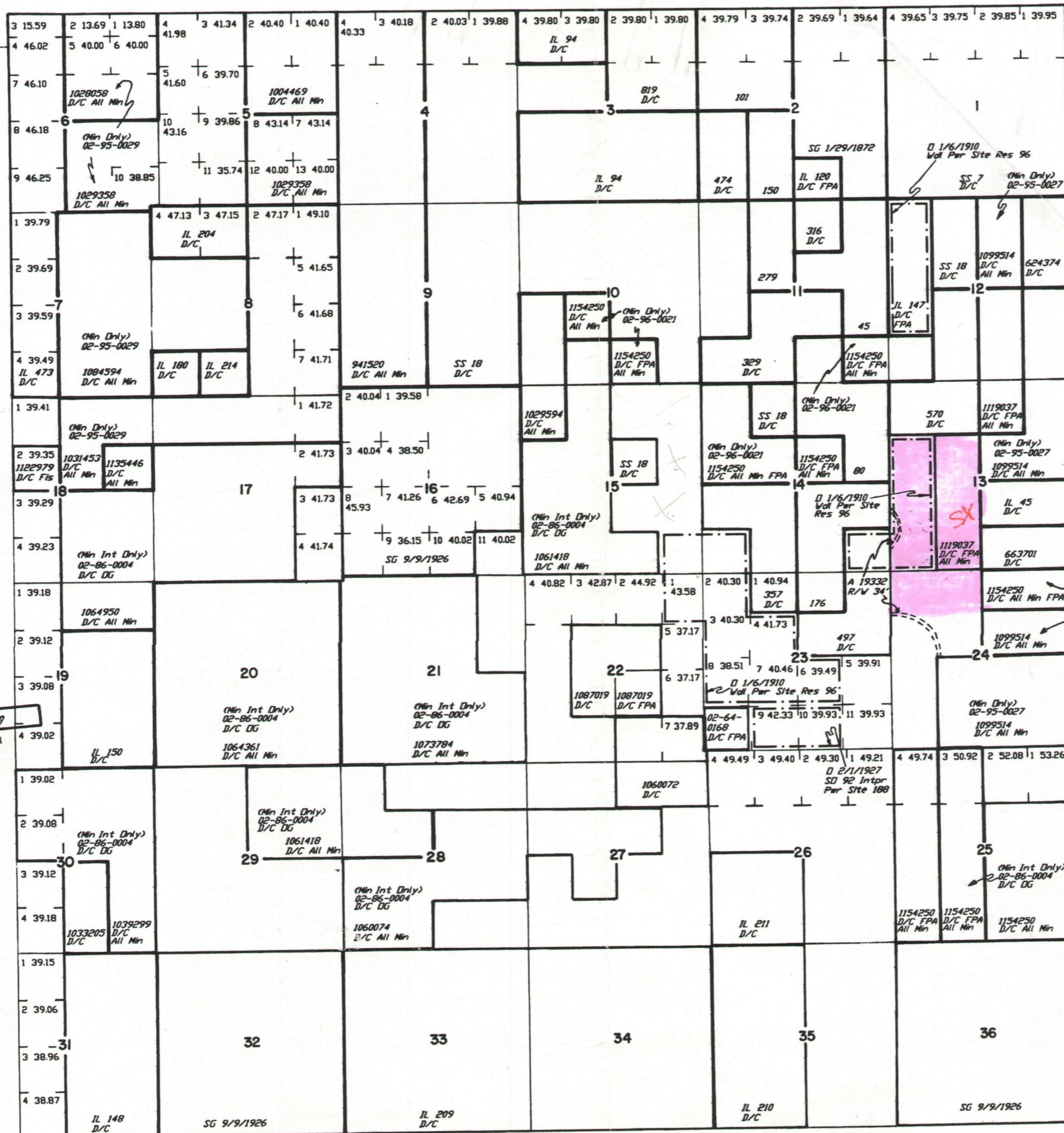

RECEIVED
 B.L.M. AZ STATE OFFICE
 1999 SEP 15 A 10:47
 PHOENIX, ARIZONA

INDEX TO SEGREGATED TRACTS				
TRACT NO	ORIGINAL SURVEY			
	T	R	SEC	SUBDIVISION

FOR ORDERS EFFECTING DISPOSAL OR USE OF UNIDENTIFIED LANDS WITHIN FOR CLASSIFICATION, MINERALS, WATER AND/OR OTHER PUBLIC PURPOSES, REFER TO INDEX OF MISCELLANEOUS DOCUMENTS.

DIST NO 2

02-96-0021 (Min Only)
 Sec 23 Lot 3, Lot 4, S1/2N1/2, S1/2E Except NE1/4 in the W1/2

(Lsbl/Salable Min Only)
 02-96-0021
 Locatable Min

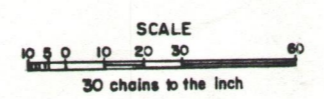

WARNING STATEMENT
 This plot is the Bureau's Record of Title, and should be used only as a graphic display of the township survey data. Records herein do not reflect title changes which may have been effected by lateral movements of pillars or other bodies of water. Refer to the original surveys for official survey information.



CURRENT TO	BY
7/21/1998	RE

T.10N
R.3W

Lat. 34° 26' 24" N
 Long. 112° 32' 03" W